

Plotted By: Chavez, Rafael Street Set: Kha Layout: C1.0 DEMOLITION PLAN November 24, 2021 02:40:28pm K:\VGA_IDE\094842021 - Fullerton College (Sherbeck Field) CAD\PlanSheets\C1.0 - DEMOLITION PLAN.dwg
This document, together with the concepts and designs presented herein, is intended only for the specific purpose and client for which it was prepared. Reuse of and improper reliance on this document without written authorization and adaptation by Kimley-Horn and Associates, Inc. shall be without liability to Kimley-Horn and Associates, Inc.

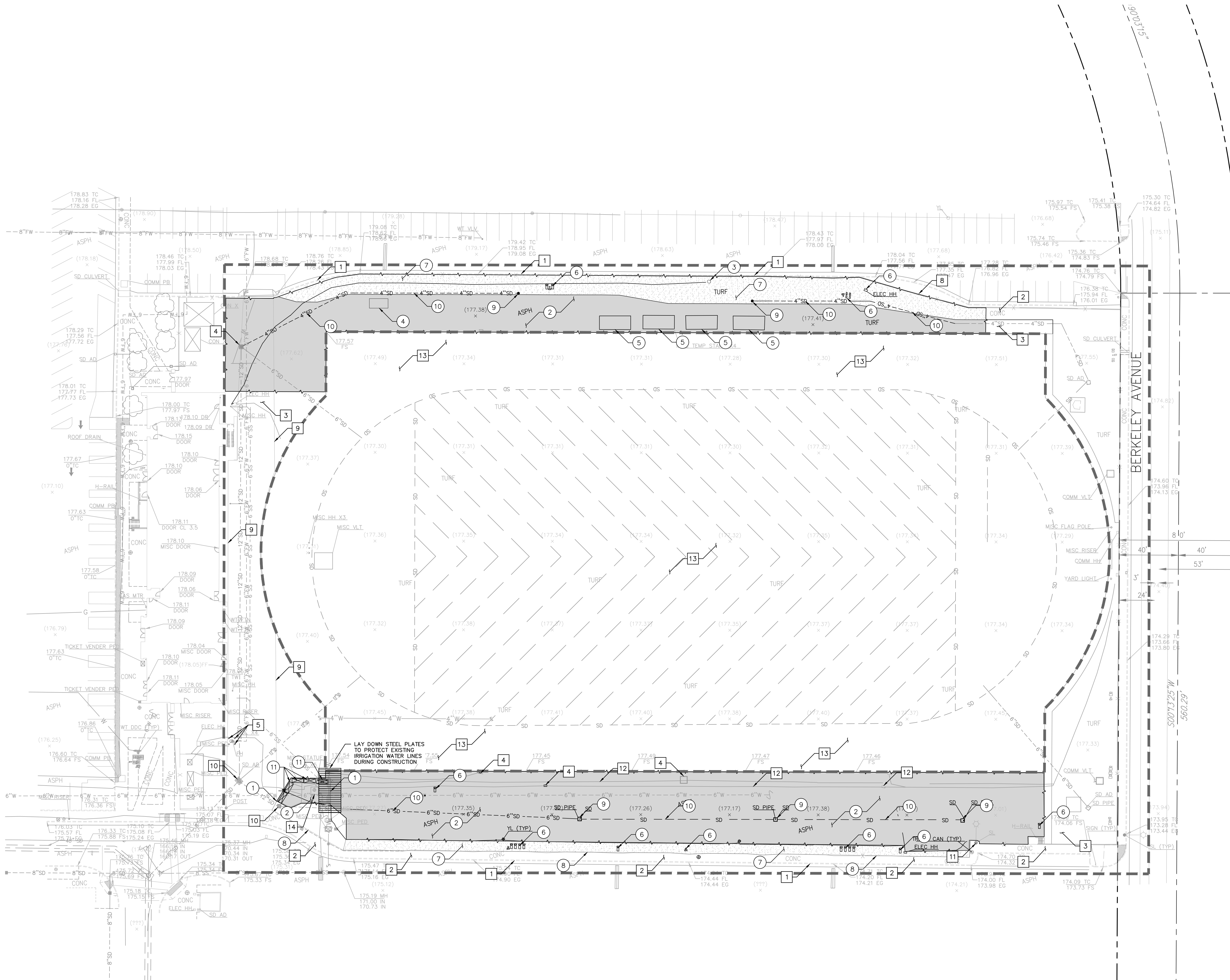

LEGEND

- LIMITS OF CIVIL WORK
- SAWCUT LINE
- EXISTING RETAINING WALL TO REMAIN
- EX. ASPHALT TO BE REMOVED INCLUDING BASE COURSE
- EX. CONCRETE TO BE REMOVED INCLUDING BASE COURSE AND REBAR
- EX. TURF TO BE REMOVED

GENERAL DEMOLITION NOTES

- THE CONTRACTOR SHALL CLEAR THE PROJECT SITE AREA WITHIN THE CONFINES OF THE DEMOLITION LIMIT LINE. THE CONTRACTOR SHALL CAP IN PLACE ALL EXISTING UTILITIES AT THE DEMOLITION LIMIT LINE, UNLESS NOTED ON THE PLAN. THE CONTRACTOR SHALL DEMOLISH AND REMOVE FROM THE SITE ALL EXISTING UTILITY STRUCTURES, PLANTERS, TREES, AND ALL OTHER SITE FEATURES, UNLESS OTHERWISE NOTED ON THE PLAN.
- DEMOLITION AND REMOVAL OF PAVEMENT INCLUDES PAVEMENT THICKNESS AS WELL AS BASE COURSE THICKNESS.
- REMOVAL OF LANDSCAPING SHALL INCLUDE ROOTS AND ORGANIC MATERIAL.
- THE CONTRACTOR SHALL BE RESPONSIBLE FOR OBTAINING ANY AND ALL PERMITS AND SHALL PAY ALL FEES NECESSARY FOR ENCROACHMENT, GRADING, DEMOLITION, AND DISPOSAL OF SAID MATERIALS AS REQUIRED BY PRIVATE, LOCAL AND STATE JURISDICTIONS.
- THE CONTRACTOR SHALL BE RESPONSIBLE FOR A SITE INSPECTION TO FULLY ACKNOWLEDGE THE EXTENT OF DEMOLITION WORK.
- THE CONTRACTOR SHALL VERIFY AND LOCATE ALL EXISTING ABOVE AND UNDERGROUND UTILITIES. LOCATIONS SHOWN ON THE PLANS ARE APPROXIMATE AND ARE SHOWN FOR GENERAL INFORMATION ONLY.
- DAMAGE TO ANY EXISTING UTILITIES AND SERVICES TO REMAIN SHALL BE THE RESPONSIBILITY OF THE CONTRACTOR. CONTRACTOR SHALL REPAIR AND/OR REPLACE IN KIND.
- EROSION CONTROL MEASURES SHALL BE IMPLEMENTED TO PREVENT DEBRIS AND UNSUITABLE MATERIALS FROM ENTERING STORM DRAINS, SANITARY SEWERS AND STREETS.
- DUST CONTROL MEASURES SHALL BE IMPLEMENTED DURING DEMOLITION.
- DEMOLITION IS LIMITED TO WITHIN THE DEMOLITION LIMIT LINE UNLESS OTHERWISE NOTED.
- CONTRACTOR SHALL REMOVE DEMOLISHED MATERIALS FROM THE SITE AS WORK PROGRESSES.
- THE DRAWINGS MAY NOT INDICATE IN DETAIL ALL DEMOLITION WORK TO BE PERFORMED. THE CONTRACTOR SHALL EXAMINE EXISTING CONDITIONS TO DETERMINE THE FULL EXTENT OF DEMOLITION.
- ALL DEMOLITION SHALL COMPLY WITH CHAPTER 24 AND ARTICLE 87 OF THE CALIFORNIA FIRE CODE.
- CONTRACTOR TO USE CARE IN HANDLING DEBRIS FROM SITE TO ENSURE THE SAFETY OF THE PUBLIC. HAUL ROUTE TO BE CLOSELY MONITORED FOR DEBRIS OR MATERIALS TRACKED ONTO ADJOINING ROADWAYS, SIDEWALKS, ETC. ROADWAYS AND WALKWAYS TO BE CLEARED DAILY OR AS NECESSARY TO MAINTAIN PUBLIC SAFETY.
- SEE EROSION CONTROL PLAN FOR REMAINING INLET PROTECTION AND EROSION PREVENTION.
- CONTRACTOR TO INSTALL CHAIN LINK FENCE WITH MESH SCREEN TO PROTECT PUBLIC FROM ENTERING CONSTRUCTION AREA.
- CONTINUOUS ACCESS SHALL BE MAINTAINED FOR SURROUNDING PROPERTIES AT ALL TIMES DURING DEMOLITION OF EXISTING FACILITIES.
- THIS PLAN IS NOT INTENDED TO BE A COMPLETE CATALOGUE OF ALL EXISTING STRUCTURES AND UTILITIES. THIS PLAN INTENDS TO DISCLOSE GENERAL INFORMATION KNOWN BY THE ENGINEER AND TO SHOW THE LIMITS OF THE AREA WHERE WORK WILL BE PERFORMED. THIS PLAN SHOWS THE EXISTING FEATURES TAKEN FROM A FIELD SURVEY. FIELD INVESTIGATIONS AND OTHER AVAILABLE INFORMATION. THIS PLAN MAY OR MAY NOT ACCURATELY REFLECT THE TYPE OR EXTENT OF THE ITEMS TO BE ENCOUNTERED AS THEY ACTUALLY EXIST. WHERE EXISTING FEATURES ARE NOT SHOWN, IT IS NOT IMPLIED THAT THEY ARE NOT TO BE DEMOLISHED OR REMOVED. THE CONTRACTOR SHALL PERFORM A THOROUGH FIELD INVESTIGATION AND REVIEW OF THE SITE WITHIN THE LIMIT OF WORK SHOWN IN THIS PLAN SET TO DETERMINE THE TYPE, QUANTITY AND EXTENT OF ANY AND ALL ITEMS. THE CONTRACTOR SHALL BE SOLELY RESPONSIBLE FOR DETERMINING THE EXTENT OF EXISTING STRUCTURES AND UTILITIES AND QUANTITY OF WORK INVOLVED IN REMOVING THESE ITEMS FROM THE SITE.

DEMOLITION

- DEMOLISH EXISTING CONCRETE CURB INCL. BASE COURSE AND REBARS IF FOUND.
- DEMOLISH EXISTING ASPHALT PAVEMENT INCL. BASE COURSE
- REMOVE EXISTING SIGNAGE POST INCL. FOUNDATION
- REMOVE EXISTING SHED AND APPURTENANCES. CONTRACTOR TO ASK IF OWNER WOULD LIKE TO SALVAGE AND RELOCATE AT OWNERS EXPENSE.
- REMOVE EXISTING TEMPORARY STANDS. CONTRACTOR TO ASK IF OWNER WOULD LIKE TO SALVAGE AND RELOCATE AT OWNERS EXPENSE.
- REMOVE EXISTING ELECTRICAL BOX AND APPURTENANCES
- REMOVE EXISTING PLANTER/TURF.
- REMOVE EXISTING FENCING INCLUDING FOUNDATION
- REMOVE EXISTING STORM DRAIN INLET
- REMOVE EXISTING STORM DRAIN PIPE
- REMOVE EXISTING SITE FURNISHING INCL. ANY FOUNDATIONS

PROTECT IN PLACE

- PROTECT-IN-PLACE EXISTING CURB
- PROTECT-IN-PLACE EXISTING CONCRETE
- PROTECT-IN-PLACE EXISTING ASPHALT
- PROTECT-IN-PLACE UTILITY STRUCTURE. ADJUST TO GRADE AS NECESSARY
- PROTECT-IN-PLACE BOLLARDS
- PROTECT-IN-PLACE METAL POST
- PROTECT-IN-PLACE EXISTING PLANTER
- PROTECT-IN-PLACE EXISTING WALL
- PROTECT-IN-PLACE EXISTING STRIPING
- PROTECT-IN-PLACE STORM DRAIN INLET
- PROTECT-IN-PLACE EXISTING LIGHT POLE
- PROTECT-IN-PLACE EXISTING UTILITY. SEE MEP PLANS FOR ADDITIONAL NOTES
- PROTECT IN PLACE EXISTING TURF/TRACK
- PROTECT-IN-PLACE EXISTING STATUE AND PAD

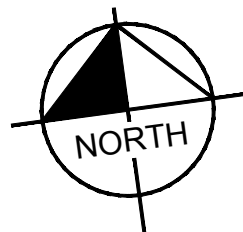

GRAPHIC SCALE IN FEET
0 15 30 60
SCALE: 1" = 30'
(WHEN PRINTED ON FULL SIZE 30"x42")

STATE:

ARCHITECT:



CONSULTANT:



PROJECT NAME:

Fullerton College
Sherbeck Field Upgrades
321 E Chapman Ave
Fullerton Ca. 92832

CLIENT:

NORTH ORANGE
COUNTY COMMUNITY
COLLEGE DISTRICT
1830 W. ROMNEYA
DRIVE, ANAHEIM,
CA 92801

Rev. Date Description

JOB NO: 094842021

DATE: 10/18/2021

DRAWN: RC

CHECK: DL

ARCHITECT: PDW

ENGINEER:

SHEET DESCRIPTION:

DEMOLITION
PLAN

SHEET NO:

C1.0

Plotted By: Chavez, Rafael Street Set: Kimley-Horn Erosion Control Plan November 22, 2021 03:31:54pm K:\ORA_LDEV_09484201 - Fullerton College (Sherbeck Field)\CAD\PlanSheets\CL1 - EROSION CONTROL PLAN.dwg
This document, together with the concepts and designs presented herein, is intended only for the specific purpose and client for which it was prepared. Reuse of any part of this document without written authorization and adaptation by Kimley-Horn and Associates, Inc. shall be without liability to Kimley-Horn and Associates, Inc.

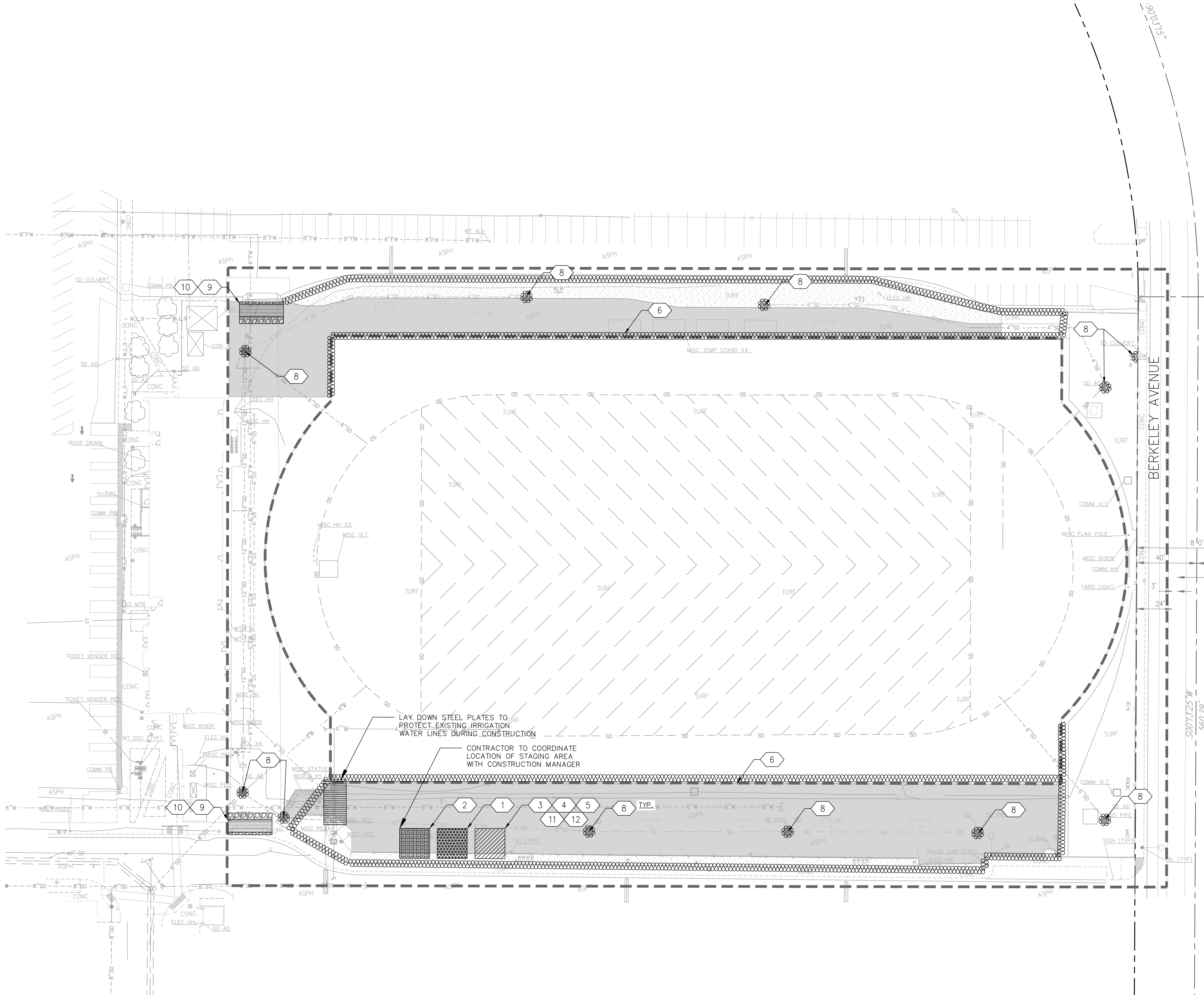

BMP NOTES

THE FOLLOWING BMPs AS OUTLINED IN, BUT NOT LIMITED TO, THE CALIFORNIA STORMWATER BMP HANDBOOK DATED NOVEMBER 2009, OR THE LATEST REVISED EDITION, MAY APPLY DURING THE CONSTRUCTION OF THE PROJECT. ADDITIONAL MEASURES MAY BE REQUIRED AS NEEDED:

- EC-1, SCHEDULING
- EC-2, PRESERVATION OF EXISTING VEGETATION
- EC-3, HYDRAULIC MULCH
- WE-1, WIND EROSION CONTROL
- NS-1, WATER CONSERVATION PRACTICES
- NS-3, PAVING AND GRINDING OPERATIONS
- NS-7, POTABLE WATER/IRRIGATION
- NS-12, CONCRETE CURING
- NS-13, CONCRETE FINISHING
- WM-4, SPILL PREVENTION AND CONTROL
- WM-5, SOLID WASTE MANAGEMENT
- WM-7, CONTAMINATED SOIL MANAGEMENT
- WM-9, SANITARY/SEPTIC WASTE MANAGEMENT
- WM-10, LIQUID WASTE MANAGEMENT
- SE-7, STREET SWEEPING AND VACUUMING

CONTRACTOR RESPONSIBLE FOR TRAFFIC CONTROL AND PEDESTRIAN CONTROL WHILE PERFORMING WORK IN THE PUBLIC RIGHT-OF-WAY.

SITE PREPARATION SHOULD BE IN ACCORDANCE WITH GEOTECHNICAL INVESTIGATION.

CONTRACTOR TO USE BEST MANAGEMENT PRACTICES TO ENSURE COMPLIANCE WITH NPDES AND WATER MANAGEMENT DISTRICT REGULATIONS FOR STORMWATER DISCHARGE FROM CONSTRUCTION ACTIVITIES AND DEWATERING OPERATIONS.

SEQUENCE OF CONSTRUCTION

UPON IMPLEMENTATION AND INSTALLATION OF THE FOLLOWING AREAS: TRAILER, PARKING, LAYDOWN, PORTA-POTTY, WHEEL WASH, CONCRETE WASHOUT, FUEL AND MATERIAL STORAGE CONTAINERS, SOLID WASTE CONTAINERS, ETC., IMMEDIATELY DENOTE THEM ON THE SITE MAPS AND NOTE ANY CHANGES IN LOCATION AS THEY OCCUR THROUGHOUT THE CONSTRUCTION PROCESS.

- PHASE 1:
- CONSTRUCT STABILIZED CONSTRUCTION ENTRANCE (1) AND CHAIN LINK FENCE WITH GREEN SCREEN AND THEN STRAW WATTLE WHERE SHOWN ON PLAN.
 - INSTALL INLET PROTECTION AT EXISTING INLET(S).
 - INSTALL AND STABILIZE ANY NECESSARY HYDRAULIC CONTROL STRUCTURES
 - PREPARE CLEARING AND GRUBBING OF THE SITE, IF APPLICABLE.

- PHASE 2:
- PERFORM MASS GRADING, ROUGH GRADE TO ESTABLISH PROPOSED DRAINAGE PATTERNS.
 - START CONSTRUCTION OF THE BUILDING PAD AND STRUCTURES.
 - TEMPORARILY SEED WITH PURE LIVE SEED, THROUGHOUT CONSTRUCTION, DISTURBED AREAS THAT WILL BE INACTIVE FOR 7 DAYS OR MORE OR AS REQUIRED BY GENERIC PERMIT.

LEGEND

- PROPERTY LINE
- CIVIL LIMIT OF WORK LINE
- CHAINLINK FENCE
- SILT FENCE
- FIBER ROLLS
- SANDBAGS
- INLET PROTECTION
- CONSTRUCTION ENTRANCE
- STOCKPILE AREA
- SANITARY AREA, TRASH STORAGE, HAZARDOUS MATERIAL, CONCRETE MANAGEMENT, VEHICLE MAINTENANCE AND EQUIPMENT STORAGE AREA
- MATERIAL STORAGE AND DELIVERY

EROSION CONTROL NOTES

- WM-1, MATERIAL DELIVERY AND STORAGE
- WM-3, STOCKPILE MANAGEMENT, CONTRACTOR TO SET UP STOCKPILE AREA
- WM-5, SANITARY AREA
- WM-6, HAZARDOUS WASTE MANAGEMENT
- WM-8, CONCRETE WASTE MANAGEMENT
- SE-5, FIBER ROLLS/STRAW WATTLE; REFER TO DETAIL 5, PER C 601. CONTRACTOR TO MAINTAIN DURING ALL GRADING & MOBILIZATION ACTIVITIES
- SE-1, SILT FENCE; REFER TO DETAIL 1, PER CIVIL DETAIL SHEET C 601. CONTRACTOR TO MAINTAIN DURING ALL GRADING & MOBILIZATION ACTIVITIES.
- SE-10, STORM DRAIN INLET PROTECTION. REFER TO DETAIL 4, PER C 601
- TR-1, STABILIZED CONSTRUCTION ENTRANCE/EXIT; REFER TO DETAIL 3, PER C 601
- TR-3, ENTRANCE/OUTLET TIRE WASH; REFER TO DETAIL 6, PER C 601
- NS-10, VEHICLE AND EQUIPMENT MAINTENANCE
- SD-32, TRASH STORAGE AREA

GENERAL EROSION CONTROL NOTES

- ERODED SEDIMENTS AND OTHER POLLUTANTS MUST BE RETAINED ON SITE AND MAY NOT BE TRANSPORTED FROM THE SITE VIA SHEET PLOW, SWALES, AREA DRAINS, NATURAL DRAINAGE COURSES OR WIND.
- STOCKPILES OF EARTH AND OTHER CONSTRUCTION RELATED MATERIALS MUST BE PROTECTED FROM BEING TRANSPORTED FROM THE SITE BY THE FORCES OF WIND OR WATER.
- FUELS, OILS, SOLVENTS, AND OTHER TOXIC MATERIALS MUST BE STORED IN ACCORDANCE WITH THEIR LISTING AND MUST NOT CONTAMINATE THE SOIL AND SURFACE WATERS. ALL APPROVED STORAGE CONTAINERS ARE TO BE PROTECTED FROM THE WEATHER. SPILLS MUST BE CLEANED UP IMMEDIATELY AND DISPOSED OF IN A PROPER MANNER. SPILLS MAY NOT BE WASHED INTO THE DRAINAGE SYSTEM.
- EXCESS OR WASTE CONCRETE MAY NOT BE WASHED INTO THE PUBLIC WAY OR ANY OTHER DRAINAGE SYSTEM. PROVISIONS SHALL BE MADE TO RETAIN CONCRETE WASTES ON SITE UNTIL THEY CAN BE DISPOSED OF AS SOLID WASTE.
- TRASH AND CONSTRUCTION RELATED SOLID WASTES MUST BE DEPOSITED INTO A COVERED RECEPTACLE TO PREVENT CONTAMINATION OF RAINWATER AND DISPERSAL BY WIND.
- SEDIMENTS AND OTHER MATERIALS MAY NOT BE TRACKED FROM THE SITE BY VEHICLE TRAFFIC. THE CONSTRUCTION ENTRANCE ROADWAYS MUST BE STABILIZED SO AS TO INHIBIT SEDIMENTS FROM BEING DEPOSITED INTO THE PUBLIC WAY. ACCIDENTAL DEPOSITIONS MUST BE SWEEPED UP IMMEDIATELY AND MAY NOT BE WASHED DOWN BY RAIN OR ANY OTHER MEANS.
- ANY SLOPES WITH DISTURBED SOILS OR DENUDED OF VEGETATION MUST BE STABILIZED SO AS TO INHIBIT EROSION BY WIND AND WATER.
- STORM WATER POLLUTION CONTROL REQUIREMENTS MUST BE INTEGRATED ONTO THE EROSION CONTROL PLANS FOR ANY CONSTRUCTION BETWEEN OCTOBER 1 AND APRIL 15. THE FOLLOWING NOTES AND BMP'S AS OUTLINED IN, BUT NOT LIMITED TO, THE BEST MANAGEMENT PRACTICE HANDBOOK, CALIFORNIA STORM WATER QUALITY TASK FORCE SACRAMENTO, CALIFORNIA 1993, OR THE LATEST REVISED EDITION MAY APPLY DURING THE CONSTRUCTION OF PROJECT (ADDITIONAL MEASURES MAY BE REQUIRED IF DEEMED APPROPRIATE BY CITY INSPECTIONS).
- TEMPORARY EROSION CONTROL DEVICES SHOWN ON THE PLAN WHICH INTERFERE WITH THE WORK SHALL BE RELOCATED OR MODIFIED AS AND WHEN THE CONTRACTOR AND/OR THE INSPECTOR SO DIRECTS AS THE WORK PROGRESSES.
- ALL STANDARDS REFERENCED FROM 2009 CASQA CONSTRUCTION BMP BOOK.

MAINTENANCE NOTES

ALL MEASURES STATED ON THIS SITE MAP, AND IN THE STORM WATER POLLUTION PREVENTION PLAN, SHALL BE MAINTAINED IN FULLY FUNCTIONAL CONDITION UNTIL NO LONGER REQUIRED FOR A COMPLETED PHASE OF WORK OR FINAL STABILIZATION OF THE SITE. ALL EROSION AND SEDIMENTATION CONTROL MEASURES SHALL BE CHECKED BY A QUALIFIED PERSON IN ACCORDANCE WITH THE CONTRACT DOCUMENTS OR THE APPLICABLE PERMIT, WHICHEVER IS MORE STRINGENT, AND REPAIRED IN ACCORDANCE WITH THE FOLLOWING:

- INLET PROTECTION DEVICES AND BARRIERS SHALL BE REPAIRED OR REPLACED IF THEY SHOW SIGNS OF UNDERMINING OR DETERIORATION.
- ALL SEEDED AREAS SHALL BE CHECKED REGULARLY TO SEE THAT A GOOD STAND IS MAINTAINED. AREAS SHOULD BE FERTILIZED, WATERED, AND RESEED AS NEEDED.
- THE CONSTRUCTION EXITS SHALL BE MAINTAINED IN A CONDITION WHICH WILL PREVENT TRACKING OR FLOW OF MUD ONTO PUBLIC RIGHTS-OF-WAY. THIS MAY REQUIRE PERIODIC TOP DRESSING OF THE CONSTRUCTION EXITS AS CONDITIONS DEMAND.
- THE TEMPORARY PARKING AND STORAGE AREA SHALL BE KEPT IN GOOD CONDITION (SUITABLE FOR PARKING AND STORAGE). THIS MAY REQUIRE PERIODIC TOP DRESSING OF THE TEMPORARY PARKING AREA AS CONDITIONS DEMAND.
- OUTLET STRUCTURES IN THE SEDIMENTATION BASINS SHALL BE MAINTAINED IN OPERATIONAL CONDITIONS AT ALL TIMES. SEDIMENT SHALL BE REMOVED FROM SEDIMENT BASINS OR TRAPS WHEN THE DESIGN CAPACITY HAS BEEN REDUCED BY 50%.

STATE:

ARCHITECT:

westbergwhite
14471 CHAMBERS RD, SUITE 210
TUSTIN, CA 92780
(714) 508-1780 508-1790 FAX

CONSULTANT:

Kimley»Horn
© 2020 KIMLEY-HORN AND ASSOCIATES, INC.
765 CHRYSLER DRIVE, SUITE 200, TUSTIN, CA 92780
PHONE: 714-939-1030 FAX: 714-939-9768
WWW.KIMLEY-HORN.COM



PROJECT NAME:

Fullerton College
Sherbeck Field Upgrades
321 E Chapman Ave
Fullerton Ca. 92832

CLIENT:

NORTH ORANGE
COUNTY COMMUNITY
COLLEGE DISTRICT

1830 W. ROMNEYA
DRIVE, ANAHEIM,
CA 92801

Rev. Date Description

JOB NO: 094842021

DATE: 10/18/2021

DRAWN: RC

CHECK: DL

ARCHITECT: PDW

ENGINEER:

SHEET DESCRIPTION:

EROSION
CONTROL
PLAN

SHEET NO:

