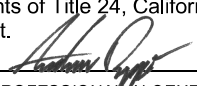

APPLICATION FOR SUBMITTAL OF POST-APPROVAL DOCUMENT

This application is for submittal of documents, after the initial approval of the project (post-approval documents), that require Division of the State Architect (DSA) review and approval. This form shall be completed by the Design Professional in General Responsible Charge of the project, in accordance with California Code of Regulations, Title 24, Part 1, Sections 4-317, 4-323 and 4-338 and in compliance with DSA IR A-6: Construction Change Document Submittal and Approval Process.

DSA documents referenced within this form are available on the [DSA Forms](#) or [DSA Publications](#) webpages.

1. SUBMITTAL TYPE: (Is this a resubmittal? Yes <input checked="" type="checkbox"/> No <input type="checkbox"/>)			
Deferred Submittal <input type="checkbox"/>	Addendum Number: <u>1</u>	Revision Number:	CCD Number: Category A <input type="checkbox"/> or B <input type="checkbox"/>
2. PROJECT INFORMATION:			
School District/Owner: <u>North Orange County Community College District</u>		DSA File Number:	
Project Name/School: <u>NOCCCD Anaheim Campus</u>		DSA Application Number <u>04 119326</u>	
3. APPLICANT INFORMATION:			
Date Submitted: <u>02/18/22</u>		Attached Pages? No <input type="checkbox"/> Yes <input checked="" type="checkbox"/> Number of pages? <u>6</u>	
Firm Name: <u>David Evans & Associates, Inc.</u>		Contact Name: <u>Linda Sandusky</u>	
Work Email: <u>LSandusky@deainc.com</u>		Work Phone: <u>(714) 665-4549</u>	
Firm Address: <u>David Evans & Associates, Inc.</u>		City: <u>Tustin</u>	State: <u>CA</u> Zip Code: <u>92780</u>
4. REASON FOR SUBMITTAL: (Check applicable boxes)			
<input checked="" type="checkbox"/> For revision or addendum prior to construction.		<input type="checkbox"/> For a project currently under construction.	
<input type="checkbox"/> For a project that has a form DSA 301-N: Notification of Requirement for Certification, DSA 301-P: Posted Notification of Requirement for Certification or a 90-Day Letter issued.			
<input type="checkbox"/> To obtain DSA approval of an existing uncertified building or buildings.			
<input type="checkbox"/> For Category B CCD this is: <input type="checkbox"/> a voluntary submittal, <input type="checkbox"/> a DSA required submittal (attach DSA notice requiring submission).			
5. DESIGN PROFESSIONAL IN GENERAL RESPONSIBLE CHARGE:			
Name of the Design Professional In General Responsible Charge: <u>Andrew Rappe</u>			
Professional License Number: <u>C83702</u>		Discipline: <u>Civil Engineer</u>	
Design Professional in General Responsible Charge Statement: The attached post-approval documents have been examined by me for design intent and appear to meet the appropriate requirements of Title 24, California Code of Regulations and the project specifications. They are acceptable for incorporation into the construction of the project.			
Signature: 		<small>DIGITALLY SIGNED 2022.03.15 14:32:48-07'00'</small>	
<i>DESIGN PROFESSIONAL IN GENERAL RESPONSIBLE CHARGE</i>			
6. CONFIRMATION, DESCRIPTION AND LISTING OF DOCUMENTS:			
For addenda, revisions, or CCDs: CHECK THIS BOX <input checked="" type="checkbox"/> to confirm that <i>all</i> post-approval documents have been stamped and signed by the Responsible Design Professional listed on form DSA 1: Application for Approval of Plans and Specifications for this project. (For Deferred Submittals, refer to IR A-18: Use of Construction Documents Prepared by Other Professionals, and IR A-19: Design Professional's Signature and Seal (Stamp) on Construction Documents, when applicable, for signature and seal requirements.)			
Provide a brief description of construction scope for this post-approval document (attach additional sheets if needed): <u>Updates the parking paving plan to remove several 4'x4' landscape planters within the parking lot interior.</u>			
List of DSA-approved drawings affected by this post-approval document: <u>C2.0 & C2.1</u>			

DSA USE ONLY		
SSS _____ Date _____ <input type="checkbox"/> Approved <input type="checkbox"/> Disapproved <input checked="" type="checkbox"/> Not Required Comments: _____ FLS _____ Date _____ <input type="checkbox"/> Approved <input type="checkbox"/> Disapproved <input checked="" type="checkbox"/> Not Required Comments: _____ ACS <u>SL</u> Date <u>03/17/2022</u> <input checked="" type="checkbox"/> Approved <input type="checkbox"/> Disapproved <input type="checkbox"/> Not Required Comments: _____	Returned Date: <u>03/18/2022</u> By: <u>DP</u>	DSA STAMP <div style="border: 2px solid black; border-radius: 15px; padding: 10px; margin: 10px auto; width: 80%;"> APPROVED DIV. OF THE STATE ARCHITECT APP: 04-119326 INC: REVIEWED FOR SS <input type="checkbox"/> FLS <input type="checkbox"/> ACS <input checked="" type="checkbox"/> DATE: <u>03/17/2022</u> </div>

GENERAL NOTES

1. WORK PERFORMED IN THIS CONTRACT SHALL CONFORM TO:
- A. PROJECT SPECIFICATIONS.
- B. THE LATEST EDITION AND SUPPLEMENTS OF THE STANDARD SPECIFICATIONS FOR PUBLIC WORKS CONSTRUCTION (SSPWC).
2. WORK SHALL COMPLY WITH THE REQUIREMENTS OF THE WORK SPECIFIED ON THE DRAWINGS AND WITHIN THE VARIOUS NOTES SHOWN HEREIN.
3. THE EXISTING CONDITIONS SHOWN DIAGRAMMATICALLY ON THE PLANS ORIGINATED FROM AS BUILT DRAWINGS. IT SHALL BE THE RESPONSIBILITY OF THE CONTRACTOR TO RETAIN A LICENSED SURVEYOR FOR ELEVATIONS, DIMENSIONS, AND FEATURES.
4. CONSTRUCTION STAKING AND ADJUSTMENTS FOR IMPROVEMENTS SHOWN ON THESE PLANS SHALL BE PERFORMED BY A LICENSED LAND SURVEYOR PAID FOR BY THE CONTRACTOR AND INCLUDED IN THE CONTRACT.
5. PROTECT EXISTING STRUCTURES IN THE AREA OF WORK, WHETHER SHOWN ON THESE PLANTS OR NOT, WHICH ARE NOT INCLUDED IN THIS CONSTRUCTION. ANY DAMAGE RESULTING FROM THIS WORK SHALL BE REPAIRED AND/OR REPLACED TO AT LEAST THAT OF THE ORIGINAL CONDITION AT NO ADDITIONAL COST.
6. UNDERGROUND SERVICE ALERT:

BEFORE COMMENCING ANY EXCAVATION, THE CONTRACTOR SHALL OBTAIN AN UNDERGROUND SERVICE ALERT INQUIRY I.D. NUMBER BY CALLING 1-800-422-4133. TWO (2) WORKING DAYS SHALL BE ALLOWED AFTER THE I.D. NUMBER IS OBTAINED AND BEFORE THE EXCAVATION WORK IS STARTED THAT UTILITY OWNERS CAN BE NOTIFIED.

NOTE: ON-SITE AND DISTRICT OWNED UTILITIES ARE NOT IDENTIFIED BY USA. CONTRACTOR SHALL HIRE AN UNDERGROUND UTILITY LOCATOR FOR ALL IMPROVEMENTS OUTSIDE OF THE PUBLIC RIGHT-OF-WAY.

7. PROTECTION AND RESTORATION OF EXISTING IMPROVEMENTS:

THE CONTRACTOR SHALL BE RESPONSIBLE FOR THE PROTECTION OF PROPERTY ADJACENT TO THE WORK PER SECTION 7-9 OF THE STANDARD SPECIFICATIONS FOR PUBLIC WORKS CONSTRUCTION, LATEST EDITION.

8. KEEP THE CONSTRUCTION AREA SUFFICIENTLY DAMPENED TO CONTROL DUST CAUSED BY WORK ACTIVITIES.

9. FILL OR BACKFILL SHALL BE COMPACTED AS SPECIFIED IN THE GEOTECHNICAL REPORT.

10. VOIDS RESULTING FROM REMOVAL WORK SHALL BE FILLED WITH SUITABLE MATERIALS APPROVED BY THE OWNER RETAINED GEOTECHNICAL ENGINEER AND COMPACTED TO 90% MINIMUM DENSITY PER ASTM D-1557.

11. ADDITIONAL SURVEYS OR TESTING AS A RESULT OF CONTRACTOR ERROR OR MISINFORMATION WILL BE CHARGED TO THE CONTRACTOR.

12. ADJUST TO GRADE EXISTING MANHOLE RIMS, VALVE BOXES AND ELECTRICAL VAULT UDS TO DESIGN GRADES WITHIN THE IMPROVEMENT AREA.

13. MAINTAIN A RECORD OF LOCATION OF UTILITY MARKERS ON THE AS-BUILT PLAN AND REINSTALL THEM AFTER PAVING. REPLACE BENT OR UNUSABLE MARKERS FOR UTILITY LINES DISCOVERED WITHIN THE WORK AREA. INSTALL BRASS UTILITY MARKERS INDICATING DIRECTIONS OF LINES AT ALL CHANGES IN DIRECTIONS AFTER PAVING. INFORM THE SURVEYOR TO LOCATE AND RECORD ACTUAL LOCATIONS.

14. WHEN EXISTING UTILITIES ARE EXPOSED OR DETERMINED TO EXIST UNDER THE ROUGH GRADING SITE, CONTRACTOR SHALL PROVIDE A FLAGGED STAKE THAT INDICATES THEIR LOCATION, TYPE OF UTILITY, SIZE, PIPE MATERIAL AND DEPTH. STAKES SHALL BE INSTALLED NO LESS THAN 50' ON CENTER ON STRAIGHT LINES AND AT BENDS.

15. UNCLOG, CLEAN AND FLUSH THE WORK AREA DRAINAGE SYSTEM AFTER PAVING AND IMMEDIATELY BEFORE A FORECAST OF RAIN.

16. EXPORT OF MATERIAL FROM THE SITE MUST GO TO A LEGAL DUMPSITE. RECEIPTS FOR ACCEPTANCE OF EXCESS MATERIAL BY A DUMPSITE ARE REQUIRED AND MUST BE PROVIDED.

17. OBTAIN AND FILE REQUIRED PERMITS, INCLUDING NPDES (IE, NO), FROM THE APPROPRIATE JURISDICTIONAL AGENCIES FOR DISCHARGE OF GROUND WATER THAT MAY BE NECESSARY TO ACCOMPLISH EXCAVATIONS SHOWN ON THESE PLANS.

18. PROVIDE THE OWNER WITH A COMPLETE SET OF "AS-BUILT" DRAWINGS OF ALL WORK PERFORMED UNDER THIS CONTRACT, AS SHOWN WITHIN THESE CONSTRUCTION DRAWINGS. ALL FIELD CHANGES SHALL BE SHOWN IN DETAIL ON THE "AS-BUILT" DRAWINGS AND SHALL INCORPORATE AS A MINIMUM, NEW ELEVATIONS, GRADES AND ALIGNMENT OF UNDERGROUND FACILITIES WITH DIMENSIONAL TIES TO BUILDINGS OR OTHER VISIBLE IMPROVEMENTS (IF REQUIRED).

19. CONTRACTOR TO ASSUME SOLE AND COMPLETE RESPONSIBILITY FOR THE JOB SITE CONDITIONS INCLUDING SAFETY OF ALL PERSONS AND PROPERTY, DURING THE COURSE OF CONSTRUCTION OF THIS PROJECT. THIS REQUIREMENT SHALL APPLY CONTINUOUSLY, AND SHALL NOT BE LIMITED TO NORMAL WORKING HOURS.

20. ALL WORK SHALL CONFORM TO THE FOLLOWING CODE AND REGULATIONS:

- 20.1.1. 2019 CALIFORNIA BUILDING STANDARDS CODE
- PART 1 2019 CALIFORNIA ADMINISTRATIVE CODE, TITLE 24 C.C.R.
- PART 2 2019 CALIFORNIA BUILDING CODE, TITLE 24 C.C.R.
- PART 2.5 2019 CALIFORNIA RESIDENTIAL CODE, TITLE 24 C.C.R.
- PART 3 2019 CALIFORNIA ELECTRICAL CODE, TITLE 24 C.C.R.
- PART 4 2019 CALIFORNIA MECHANICAL CODE, TITLE 24 C.C.R.
- PART 5 2019 CALIFORNIA PLUMBING CODE, TITLE 24 C.C.R.
- PART 6 2019 CALIFORNIA ENERGY CODE, TITLE 24 C.C.R.
- PART 7 CURRENTLY VACANT
- PART 8 2019 CALIFORNIA HISTORICAL BUILDING CODE, TITLE 24 C.C.R.
- PART 9 2019 CALIFORNIA FIRE CODE, TITLE 24 C.C.R.
- PART 10 2019 CALIFORNIA EXISTING BUILDING CODE, TITLE 24 C.C.R.
- PART 11 2019 CALIFORNIA GREEN BUILDING STANDARDS CODE, TITLE 24 C.C.R.
- PART 12 2019 CALIFORNIA REFERENCE STANDARDS CODE, TITLE 24 C.C.R.
- 20.1.2. 2019 CALIFORNIA BUILDING CODE (FOR SEW) REFERENCE STANDARDS CHAPTER 35
- NFPA 13 AUTOMATIC SPRINKLER SYSTEMS (CALIFORNIA AMENDED), 2019 EDITION
- NFPA 14 STANDPIPE SYSTEMS (CALIFORNIA AMENDED), 2019 EDITION
- NFPA 17 DRY CHEMICAL EXTINGUISHING SYSTEMS, 2019 EDITION
- NFPA 17A WET CHEMICAL EXTINGUISHING SYSTEMS, 2019 EDITION
- NFPA 20 STATIONARY PUMPS, 2019 EDITION
- NFPA 24 PRIVATE FIRE SERVICE MAINS (CALIFORNIA AMENDED), 2019 EDITION
- NFPA 72 NATIONAL FIRE ALARM AND SIGNALING CODE (CALIFORNIA AMENDED), 2019 EDITION
- NFPA 80 FIRE DOOR AND OTHER OPENING PROTECTIVES, 2019 EDITION
- NFPA 253 CRITICAL RADIANT FLUX OF FLOOR COVERING SYSTEMS, 2019 EDITION
- NFPA 2001 CLEAN AGENT FIRE EXTINGUISHING SYSTEMS (CALIFORNIA AMENDED) 2019 EDITION.

21. CHANGES TO THE APPROVED DRAWINGS AND SPECIFICATIONS SHALL BE MADE BY AN ADDENDUM OR A CONSTRUCTION CHANGE DOCUMENT (CCD) APPROVED BY THE DIVISION OF THE STATE ARCHITECT, AS REQUIRED BY SECTION 4-215, PART 1, TITLE 24, CCR.

22. A PROJECT INSPECTOR EMPLOYED BY THE DISTRICT (OWNER) AND APPROVED BY THE DIVISION OF THE STATE ARCHITECT SHALL PROVIDE CONTINUOUS INSPECTION OF THE WORK. THE DUTIES OF THE INSPECTOR ARE DEFINED IN SECTION 4-219, PART 1, TITLE 24, CLASS 3.

23. GRADING PLANS, DRAINAGE IMPROVEMENTS, ROAD AND ACCESS REQUIREMENTS AND ENVIRONMENTAL HEALTH CONSIDERATIONS SHALL COMPLY WITH ALL LOCAL ORDINANCES.

24. THE SITE IS LOCATED WITHIN A FLOOD HAZARD ZONE "X" PER FLOOD INSURANCE RATE MAP 06059C01274; COMMUNITY NUMBER 060213; EFFECTIVE DATE: DECEMBER 03, 2009.

ACCESSIBILITY CALCULATIONS

PARKING LOT 1 AND 2:

625 PARKING STALLS EXISTING

615 PARKING STALLS PROPOSED

13 ACCESSIBLE EXISTING (3 VAN ACCESSIBLE)

13 ACCESSIBLE REQUIRED (3 VAN ACCESSIBLE)

NORTH ORANGE COUNTY COMMUNITY COLLEGE DISTRICT PARKING LOT RENOVATION

IDENTIFICATION STAMP
DIV. OF THE STATE ARCHITECT
APP. 04-119326 INC.
REVIEWED FOR
SS ☐ FLS ☐ ACS ☒
DATE: 05.13.2020

REFERENCE ONLY

SCOPE OF WORK

- A FULL REPLACEMENT OF EXISTING PARKING LOT 2. INCLUDING, BUT NOT LIMITED TO, THE FOLLOWING:
- a. UNDERGROUND UTILITY INVESTIGATION FOR THE DRY AND WET UTILITIES (IF NEEDED)
- b. REMOVE EXISTING ASPHALT (DEMOLITION INCLUDING HAUL OFF)
- c. PERFORM CONCRETE WORK (IF REQUIRED)
- d. PLACE NEW ASPHALT BASE AND CAP
- e. NEW STRIPING

SHEET INDEX

SHEET NO	DESCRIPTION
C0.0	COVER SHEET
C1.0	SITE PLAN
C2.0	PAVING PLAN
C2.1	PAVING PLAN
C3.0	STRIPING PLAN
C3.1	STRIPING PLAN

CIVIL ABBREVIATIONS

AC ASPHALTIC CONCRETE
BK BRICK
BSW BACK OF SIDEWALK
BWL BLOCK WALL
(CPP) CALCULATED PER PLAN
C&G CURB & GUTTER
CB CATCH BASIN
CBO CATCH BASIN OUTLET
CC CEMENT CONCRETE
CF CURB FACE
CLF CHAIN LINK FENCE
DDC DOUBLE DETECTOR CHECK
DI DROP INLET
DWY DRIVEWAY
ECAB ELECTRICAL CABINET
EG EDGE OF GUTTER
EOC EDGE OF CONCRETE
EOP EDGE OF PAVING
ER EARTH
F FIRE
FD FOUND
FDC FIRE DEPARTMENT CONNECTOR
FF FINISH FLOOR
FL FLOW LINE
FOS FIBER OPTIC SIGN
FS FINISH SURFACE
FSC FIRE SPRINKLER CONNECTOR
GM GAS METER
GR GRAVEL
GV GAS VALVE
GW GUY WIRE
INF IRON FENCE
INV INVERT
L&T LEAD & TAG
LP LOW-POINT
MH MANHOLE

OHD OVERHEAD
OHG OVERHANG
(PP) PER PLAN
PA PLANTING AREA
PED PEDESTRIAN
PP POWER POLE
PWR POWER
RS RAILROAD SIGNAL
RTG RAILROAD TRAFFIC GATE
RW RECLAIMED WATER
S.GATE SLIDING GATE
SCO SEWER CLEAN OUT
SD STORM DRAIN
SDMH STORM DRAIN MANHOLE
SLT STREET LIGHT
SMH SEWER MANHOLE
SPK SPIKE
SW SIDEWALK
TC TOP OF CURB
TOB TOP OF CATCH BASIN
TEL TELEPHONE
TG TOP OF GRATE
TP TELEPHONE POLE
TS TRANSFORMER
TS TRAFFIC SIGNAL
TW TOP OF WALL
TYP TYPICAL
W/ WITH
WA WATER
WM WATER METER
WV WATER VALVE
YBE YARD BOX ELECTRIC LIGHT
YBSL YARD BOX STREET LIGHT
YBTS YARD BOX TRAFFIC SIGNAL

LEGEND

----- PROPERTY LINE
----- CENTER LINE
----- EASEMENT LINE
----- ROAD EASEMENT LINE
----- 114.5' CONTOUR LINE
----- CURB UNLESS OTHERWISE NOTED
X X CHAIN LINK FENCE
UNLESS OTHERWISE NOTED
O O HANDRAIL
G G UNDERGROUND GAS LINE
S S UNDERGROUND SEWER LINE
SD UNDERGROUND STORM DRAIN LINE
T T UNDERGROUND TELEPHONE LINE
W W UNDERGROUND WATER LINE

⊗ ANTENNA
BRUSH
>< CULVERT
f FLAGPOLE
FIRE HYDRANT
GATE
GRID
GUARDRAIL
HEDGE
H HORIZONTAL CONTROL
HIV HORIZONTAL VERTICAL CONTROL
MH MANHOLE
MB MAILBOX
* LIGHT POLE

○ MISC. OBJECT
* PALM
● GUARD POST
● PARKING BUMPER
* ROCK
* SIGN
100.1' SPOT ELEV.
TP/PP ● TELEPHONE POLE/
POWER POLE
● UTILITY POLE
TREE
TREES
12" TREE PLANTER
WITH TREE TRUNK DIAMETER
V VERTICAL CONTROL
B-B BORING LOCATION
B-1 BORING #

OWNER

NORTH ORANGE COUNTY COMMUNITY
COLLEGE DISTRICT
1830 W ROMNEYA DR
ANAHEIM, CA 92801

SITE ADDRESS

NORTH ORANGE COUNTY COMMUNITY
COLLEGE DISTRICT
1830 W ROMNEYA DR
ANAHEIM, CA 92801

CIVIL ENGINEER

DAVID EVANS AND ASSOC.
17TH STREET, SUITE 200
TUSTIN, CA 92780-1947
PH: (714) 665-4500
FX: (714) 665-4501
ATTN: LINDA SANDUSKY

SOILS ENGINEER

GEOTECHNICAL SOLUTIONS, INC.
27 MAUKCHY, SUITE 210
IRVINE, CA 92618
PH: (909) 606-6111
FX: (909) 606-6112
ATTN: DHARMA SHAKYA, P.E., G.E.

GEOTECHNICAL NOTE:

SITE GEOTECHNICAL INVESTIGATION REPORT PREPARED BY
GEOTECHNICAL SOLUTIONS, INC. TITLED: "GEOTECHNICAL
ENGINEERING PAVEMENT REPORT - ANAHEIM CAMPUS WEST
PARKING LOT RENOVATION", NORTH ORANGE COUNTY
COMMUNITY COLLEGE DISTRICT, 1830 WEST ROMNEYA DRIVE,
ANAHEIM, CALIFORNIA, 92801

GEOTECHNICAL SOLUTIONS PROJECT NO. SA-5627-01, DATED
AUGUST 28, 2019, INCLUDING ALL SUBSEQUENT REVISIONS.

AREA SQUARE FOOTAGES

PARKING LOT 2	134,061 SF
---------------	------------

*APPROXIMATE QUANTITIES ONLY, CONTRACTOR TO
VERIFY AND UTILIZE INDEPENDENT QUANTITIES BASED
UPON ACTUAL FIELD CONDITIONS.

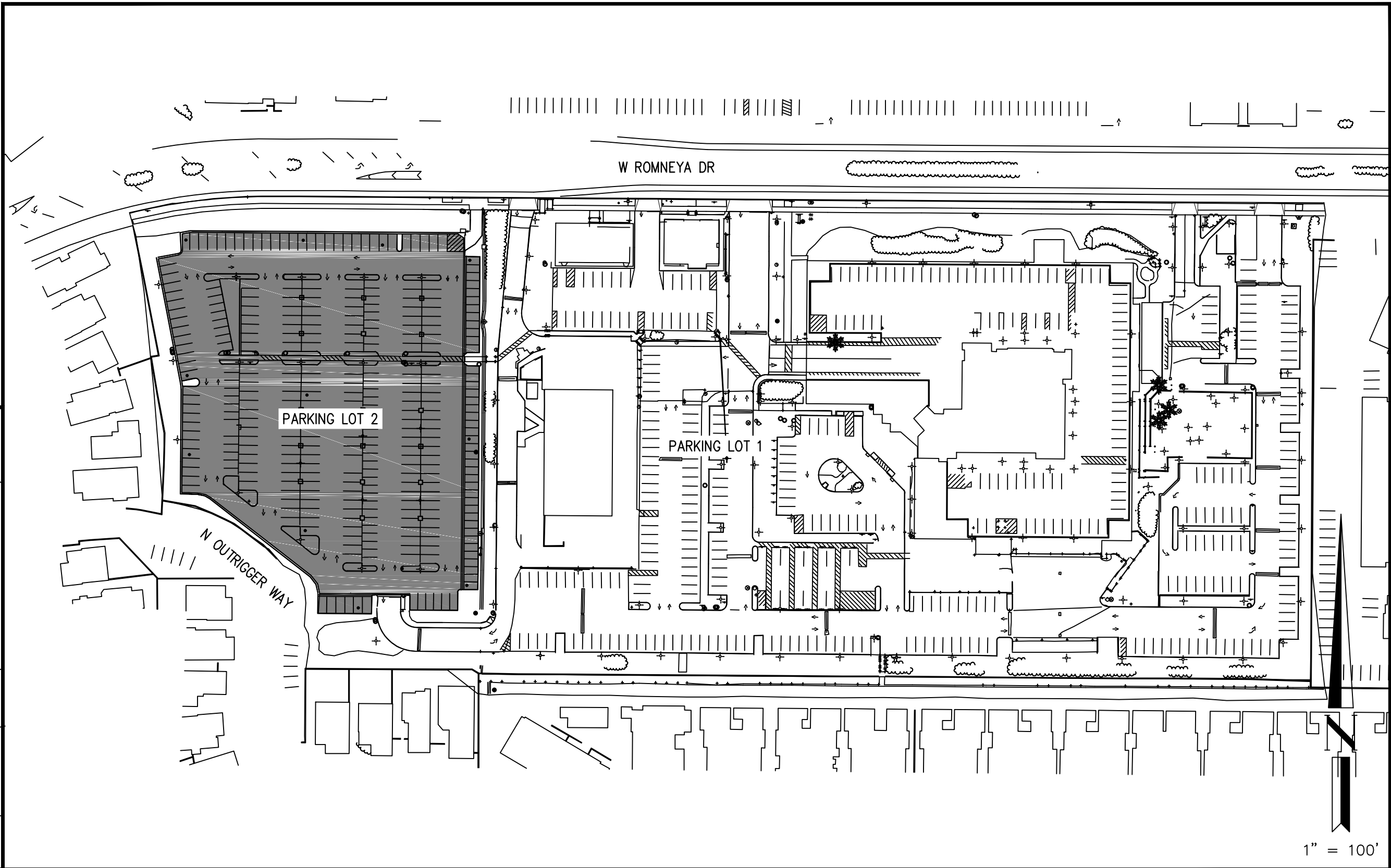
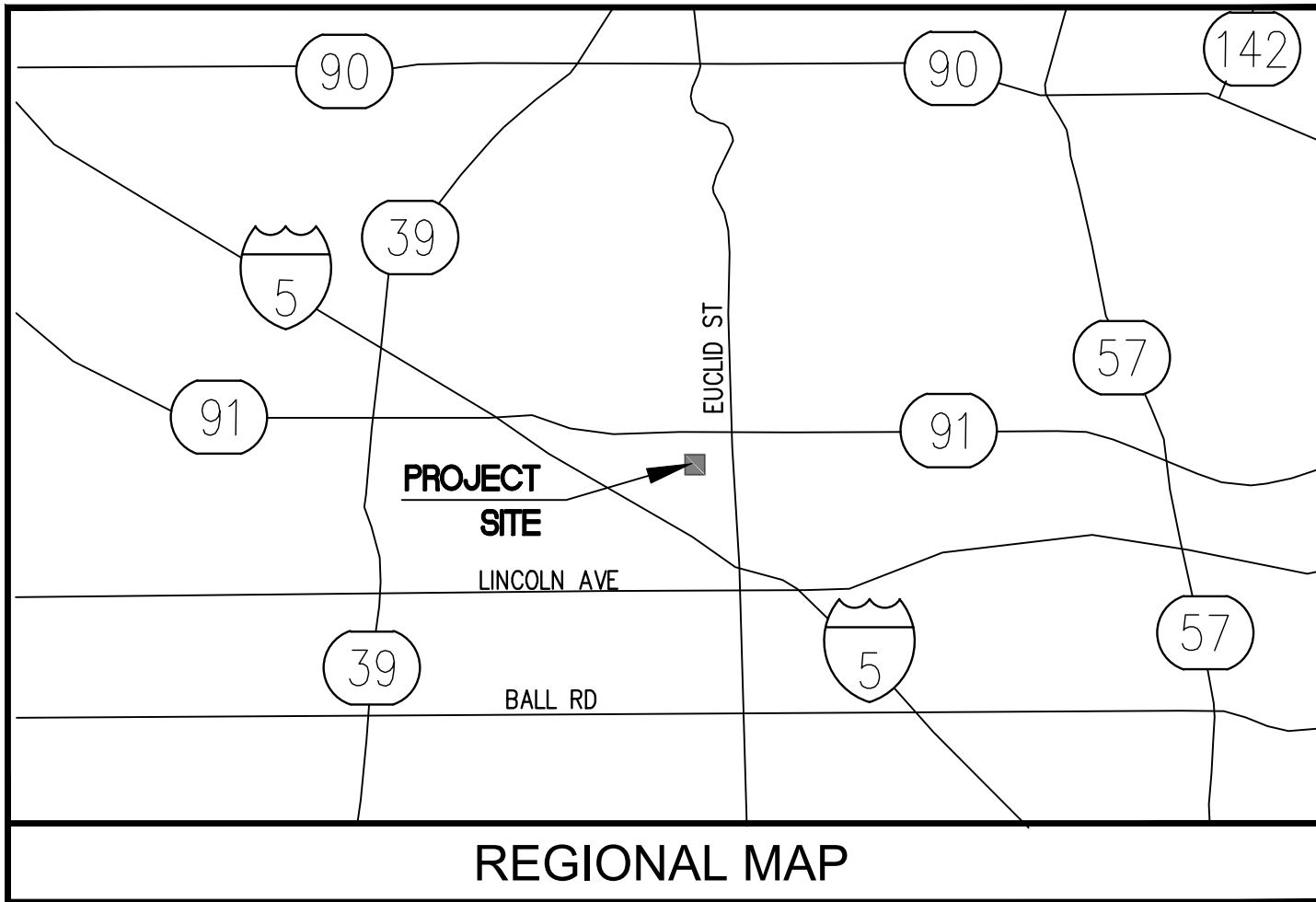

JURISDICTION

Division of the State Architect
San Diego Regional Office
10920 Via Frontera, Suite 300
San Diego, CA 92127
ph: 858.674.5400



NO.	DESCRIPTION	DATE	BY
REVISIONS			



PREPARED UNDER THE SUPERVISION OF:
ANDREW RAPPE
P.E. CB3702
05/12/20
DATE:

17782 17th Street Suite 200
Tustin California 92780-1947
Phone: 714.665.4500

NORTH ORANGE COUNTY COMMUNITY COLLEGE
PARKING LOT RENOVATION

DRAWN BY: TRCE	SCALE:
DESIGNED BY: ATR	DATE: 05/12/20
CHECKED BY: MSO	SHT NO.: C0.0

COVER SHEET

ACCESSIBILITY CALCULATIONS

PARKING LOT 1 AND 2:

596 PARKING STALLS EXISTING
615 PARKING STALLS PROPOSED
13 ACCESSIBLE EXISTING 3 VAN ACCESSIBLE
13 ACCESSIBLE REQUIRED 3 VAN ACCESSIBLE

EXISTING PARKING LOT PER DSA NO. 4-103761 ACCESS ONLY

IDENTIFICATION STAMP
DIV. OF THE STATE ARCHITECT
APP. 04-119326 INC.
REVIEWED FOR
SS ☐ FLS ☐ ACS ☐
DATE: 05.13.2020

REFERENCE ONLY

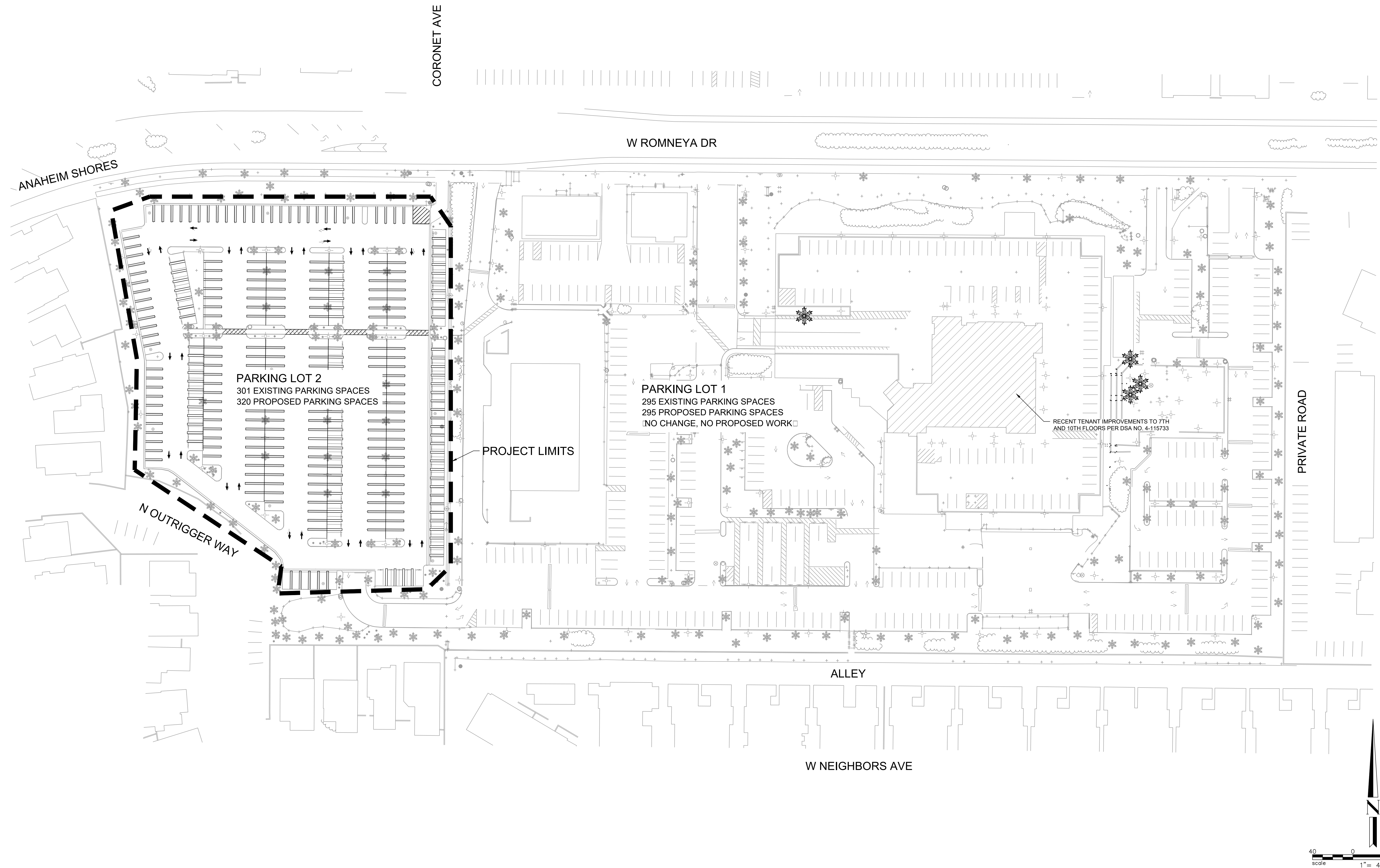

JURISDICTION

Division of the State Architect
San Diego Regional Office
10920 Via Frontera, Suite 300
San Diego, CA 92127
ph: 615.674.5400

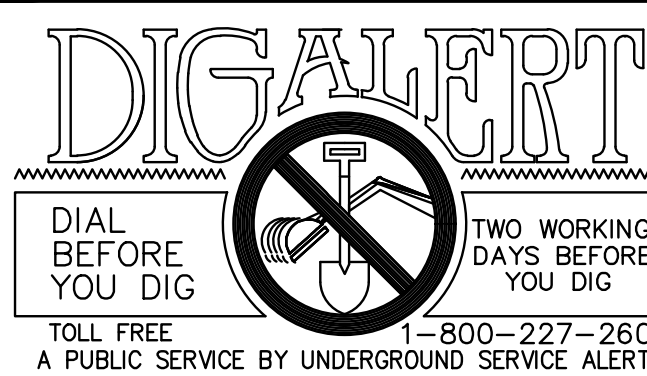

NO.	DESCRIPTION	DATE	BY
REVISIONS			

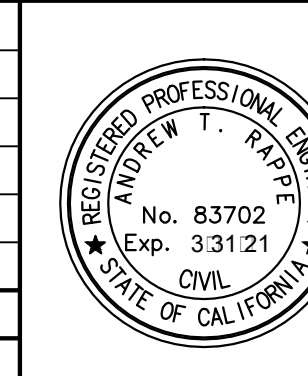

17782 17th Street Suite 200
Tustin California 92780-1947
Phone: 714.665.4500

PREPARED UNDER THE SUPERVISION OF:

ANDREW RAPPE P.E. C83702

05/12/20

DATE:

NORTH ORANGE COUNTY COMMUNITY COLLEGE

PARKING LOT RENOVATION

DRAWN BY: TRCE	SITE PLAN	SCALE:
DESIGNED BY: ATR		DATE: 05/12/20
CHECKED BY: MSO		SHT NO.: C1.0

LEGEND

- 4" AC OVER 6" AGGREGATE BASE
OVER 12" OF SCARIFIED AND
RECOMPACTED SUBGRADE
- 4" AC OVER 6" AGGREGATE BASE
OVER 12" OF SCARIFIED AND
RECOMPACTED SUBGRADE

GENERAL NOTES

1. ALL UTILITIES WITHIN THE CONSTRUCTION LIMITS ARE TO BE PROTECTED IN PLACE.
2. ALL UTILITY STRUCTURES ARE TO BE ADJUSTED TO FINAL GRADE.
3. CONTRACTOR SHALL FIELD VERIFY A.C. JOIN LIMITS PRIOR TO CONSTRUCTION.
4. LANDSCAPE INCLUDES ALL VEGETATION, TREES, AND BUSHES WITHIN THE GENERAL AREA.

CONSTRUCTION NOTES

1. PROTECT IN PLACE, AS NOTED.
2. REMOVE FULL DEPTH OF EXISTING A.C., INCLUDING BASE.
3. CONSTRUCT 4" A.C. OVER 8" OF COMPACTED AGGREGATE BASE OVER 12" OF SCARIFIED, MOISTURE CONDITIONED AND RECOMPACTED SUBGRADE PER SOILS REPORT.
4. CONSTRUCT 4" A.C. OVER 6" OF COMPACTED AGGREGATE BASE OVER 12" OF SCARIFIED, MOISTURE CONDITIONED AND RECOMPACTED SUBGRADE PER SOILS REPORT.
5. PROTECT EXISTING UTILITY IN PLACE, ADJUST AS REQUIRED.
6. REMOVE EXISTING CURB, INCLUDING BASE, AND LANDSCAPING.

ABBREVIATIONS

- GUT GUTTER
LS LANDSCAPE
PVMT PAVEMENT
MH MANHOLE
SD STORM DRAIN
SL STREET LAMP
TS TRAFFIC SIGN
UB UTILITY BOX

SEE SHEET C2.1 FOR MATCHLINE

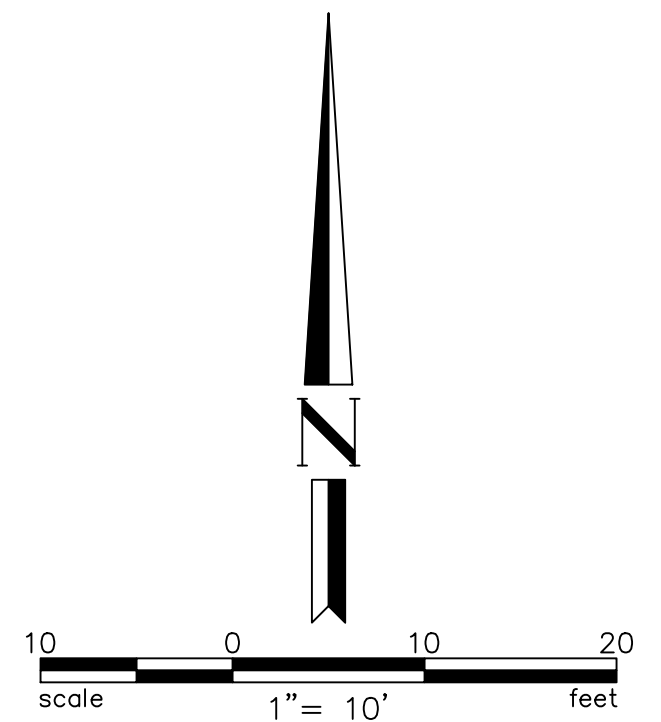

JURISDICTION

Division of the State Architect
San Diego Regional Office
10920 Via Frontera, Suite 300
San Diego, CA 92127
ph: 658.674.5400

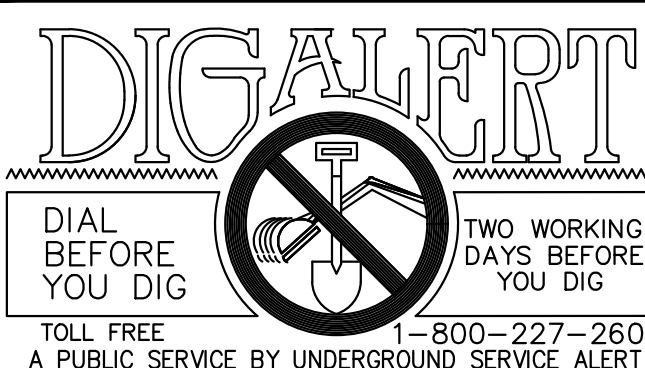

NO.	DESCRIPTION	DATE	BY
1	ADDENDUM 1 - CURB PLANTER REMOVAL	2/18/22	ATR
REVISIONS			

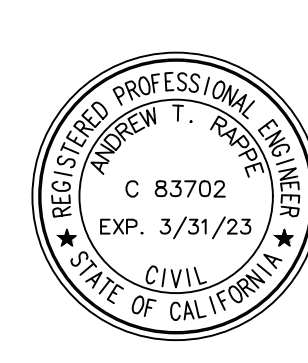

17782 17th Street Suite 200
Tustin California 92780-1947
Phone: 714.865.4500

PREPARED UNDER THE SUPERVISION OF:

DATE: 03/15/22
P.E. C83702

NORTH ORANGE COUNTY COMMUNITY COLLEGE

PARKING LOT RENOVATION

DRAWN BY: TRCE	SCALE:
DESIGNED BY: ATR	DATE: 05/12/20
CHECKED BY: MSO	SHT NO.: C2.0

LEGEND

- 4" AC OVER 8" AGGREGATE BASE
OVER 12" OF SCARIFIED AND
RECOMPACTED SUBGRADE
- 4" AC OVER 8" AGGREGATE BASE
OVER 12" OF SCARIFIED AND
RECOMPACTED SUBGRADE

GENERAL NOTES

- ALL UTILITIES WITHIN THE CONSTRUCTION LIMITS ARE TO BE PROTECTED IN PLACE.
- ALL UTILITY STRUCTURES ARE TO BE ADJUSTED TO FINAL GRADE.
- CONTRACTOR SHALL FIELD VERIFY A.C. JOIN LIMITS PRIOR TO CONSTRUCTION.
- LANDSCAPE INCLUDES ALL VEGETATION, TREES, AND BUSHES WITHIN THE GENERAL AREA.

CONSTRUCTION NOTES

- PROTECT IN PLACE. AS NOTED.
- REMOVE FULL DEPTH OF EXISTING A.C., INCLUDING BASE.
- CONSTRUCT 4" A.C. OVER 8" OF COMPACTED AGGREGATE BASE OVER 12" OF SCARIFIED, MOISTURE CONDITIONED AND RECOMPACTED SUBGRADE PER SOILS REPORT.
- CONSTRUCT 4" A.C. OVER 6" OF COMPACTED AGGREGATE BASE OVER 12" OF SCARIFIED, MOISTURE CONDITIONED AND RECOMPACTED SUBGRADE PER SOILS REPORT.
- PROTECT EXISTING UTILITY IN PLACE. ADJUST AS REQUIRED.
- REMOVE EXISTING CURB, INCLUDING BASE, AND LANDSCAPING.

ABBREVIATIONS

- FC FENCE
GUT GUTTER
LS LANDSCAPE
MH MANHOLE
PVMT PAVEMENT
SD STORM DRAIN
SL STREET LAMP
TS TRAFFIC SIGN
UB UTILITY BOX

SEE SHEET C2.0 FOR MATCHLINE

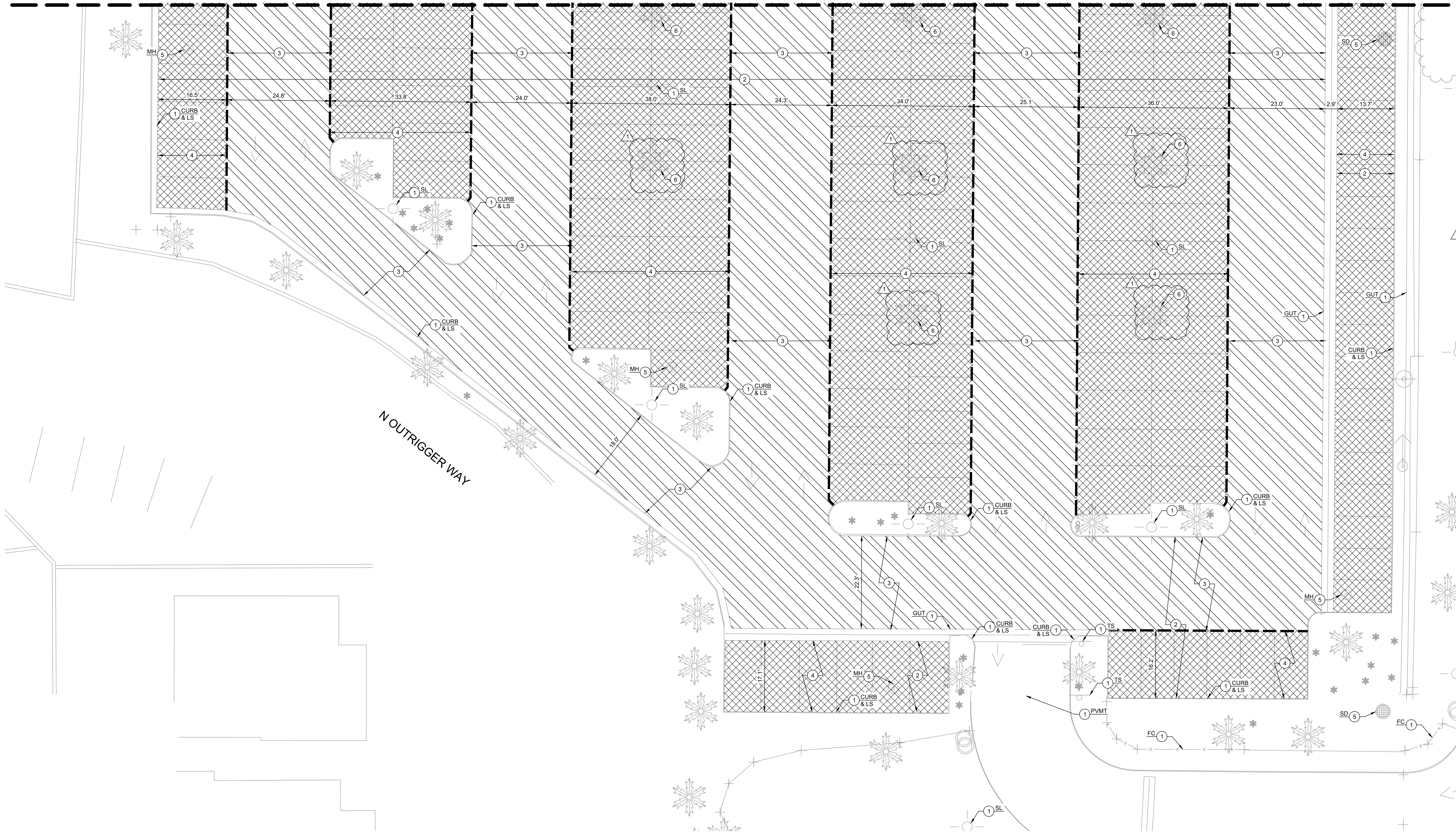

JURISDICTION
Division of the State Architect
San Diego Regional Office
10920 Via Frontera, Suite 300
San Diego, CA 92127
ph: 658.674.5400

DIG ALERT
DIAL BEFORE YOU DIG
TWO WORKING DAYS BEFORE YOU DIG
TOLL FREE 1-800-227-2600
A PUBLIC SERVICE BY UNDERGROUND SERVICE ALERT

NO.	DESCRIPTION	DATE	BY
1	ADDENDUM 1 - CURB PLANTER REMOVAL	2/18/22	ATR
REVISIONS			



DAVID EVANS AND ASSOCIATES INC.
PREPARED UNDER THE SUPERVISION OF:
ANDREW RAPPE
P.E. CB3702

17782 17th Street Suite 200
Tustin California 92780-1947
Phone: 714.665.4500
DATE: 03/15/22

NORTH ORANGE COUNTY COMMUNITY COLLEGE			
PARKING LOT RENOVATION			
DRAWN BY: TRCE	PAVING PLAN	SCALE:	
DESIGNED BY: ATR		DATE:	05/12/20
CHECKED BY: MSO		SHT NO.:	C2.1

CONSTRUCTION NOTES

- 1 PAINT 4" WIDE WHITE PARKING STALL STRIPE 2 COATS PER DETAIL 1 ON SHEET C3.1.
- 2 PAINT WHITE DIRECTIONAL ARROW 2 COATS PER DETAIL 2 ON SHEET C3.1.
- 3 PEDESTRIAN CROSSWALK STRIPING PER DETAIL 3 ON SHEET C3.1.
- 4 INSTALL WHITE 12" HEIGHT "COMPACT" LETTERS.
- 5 NO PARKING STRIPING PER DETAIL 4 ON SHEET C3.1.

SEE SHEET C3.1 FOR MATCHLINE

10 0 10 20
scale 1" = 10' feet

JURISDICTION

Division of the State Architect
San Diego Regional Office
10920 Via Frontera, Suite 300
San Diego, CA 92127
ph: 658.674.5400

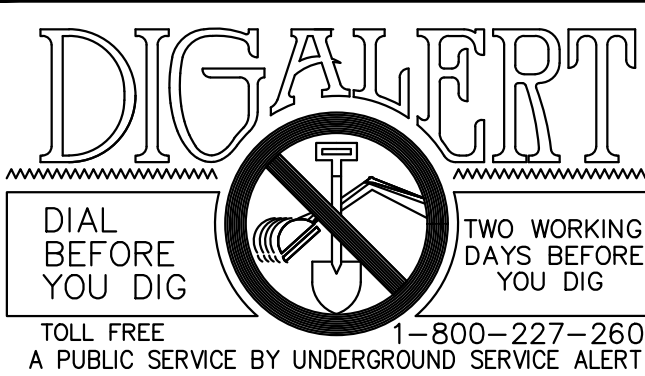

NO.	DESCRIPTION	DATE	BY
1	ADDENDUM 1 - CURB PLANTER REMOVAL	2/18/22	ATR
REVISIONS			

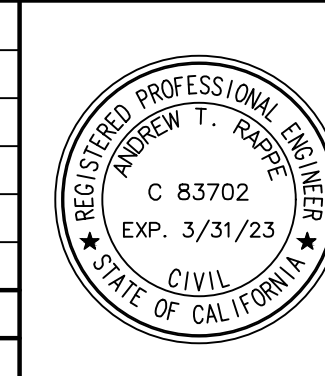

17782 17th Street Suite 200
Tustin California 92780-1947
Phone: 714.665.4500

PREPARED UNDER THE SUPERVISION OF:

ANDREW RAPPE
P.E. C83702

03/15/22
DATE:NORTH ORANGE COUNTY COMMUNITY COLLEGE
PARKING LOT RENOVATION

DRAWN BY: TRCE	SCALE:
DESIGNED BY: ATR	DATE: 05/12/20
CHECKED BY: MSO	SHT NO.: C3.0

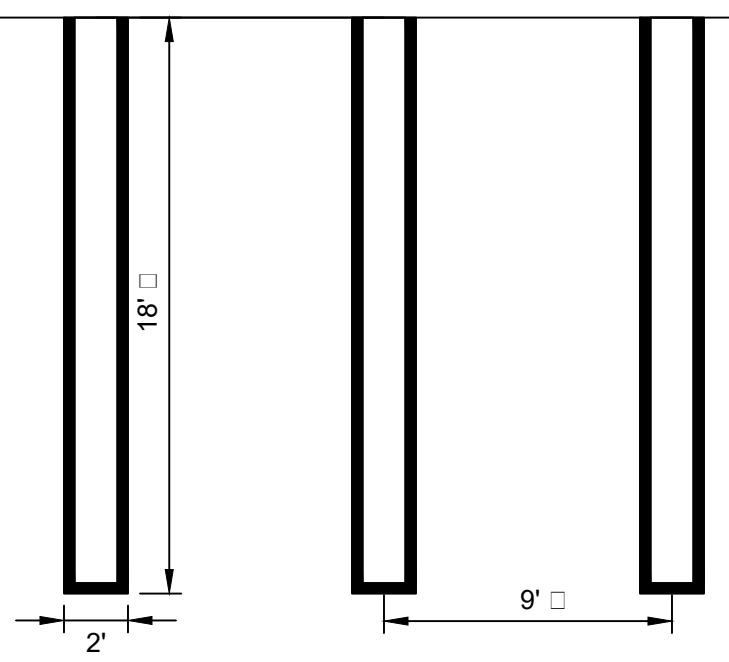

NOTES:
1. ALL STRIPING SHALL BE 4" LINES USING WHITE TRAFFIC BEARING PAINT.
2. STANDARD PARKING STALLS SHALL BE 9' WIDE X 18' LONG UNLESS OTHERWISE SHOWN ON PLAN.
3. COMPACT STALLS SHALL BE 8.5' WIDE MINIMUM, LENGTH PER PLAN.

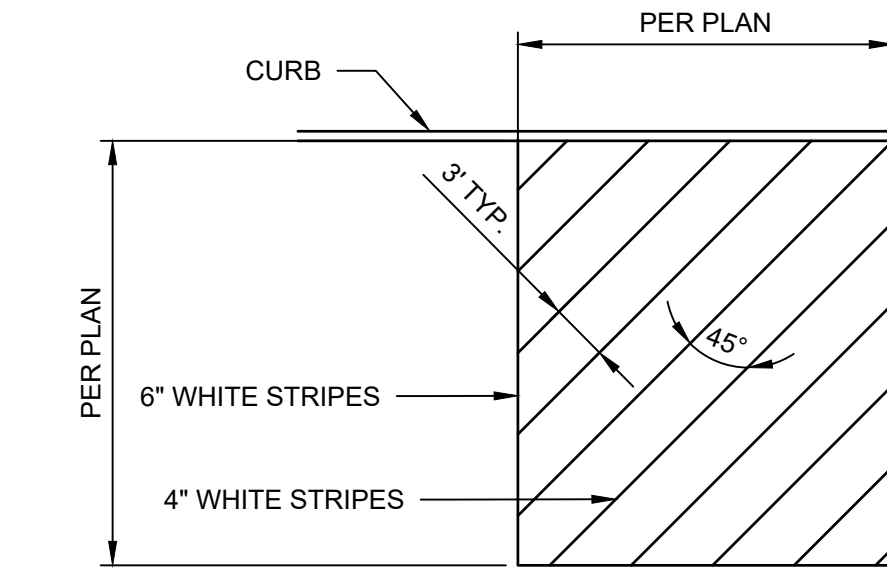
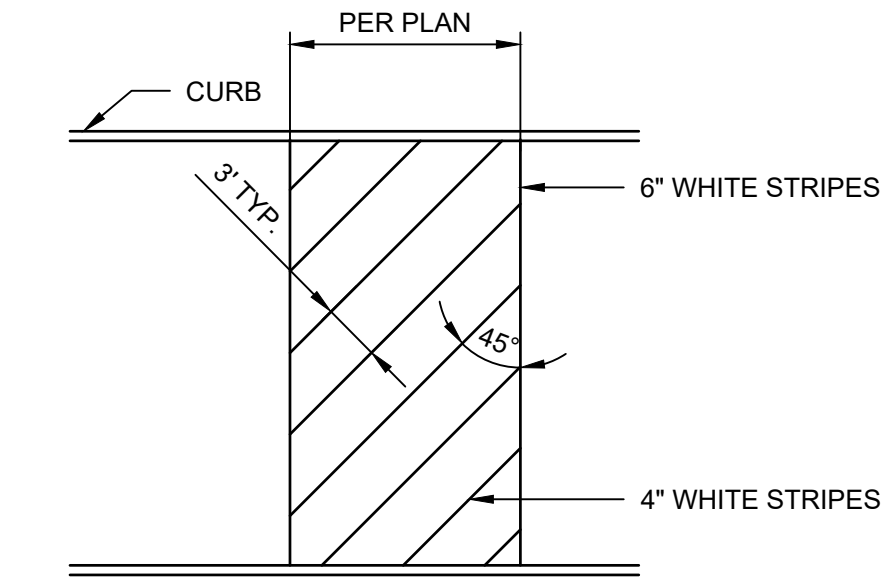
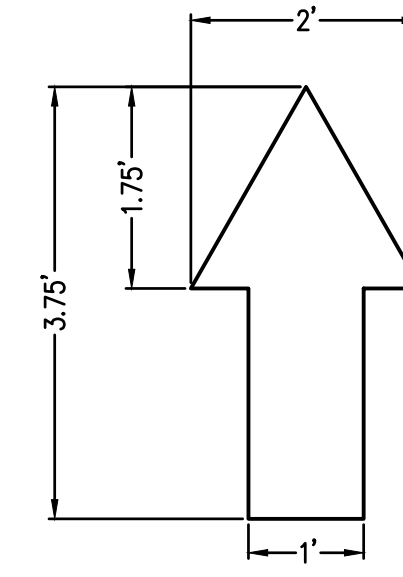

1 PARKING SPACES
N.T.S.

2 DIRECTIONAL ARROW
N.T.S.

3 CROSSWALK STRIPING
N.T.S.

4 CROSSWALK STRIPING
N.T.S.

SEE SHEET C3.0 FOR MATCHLINE

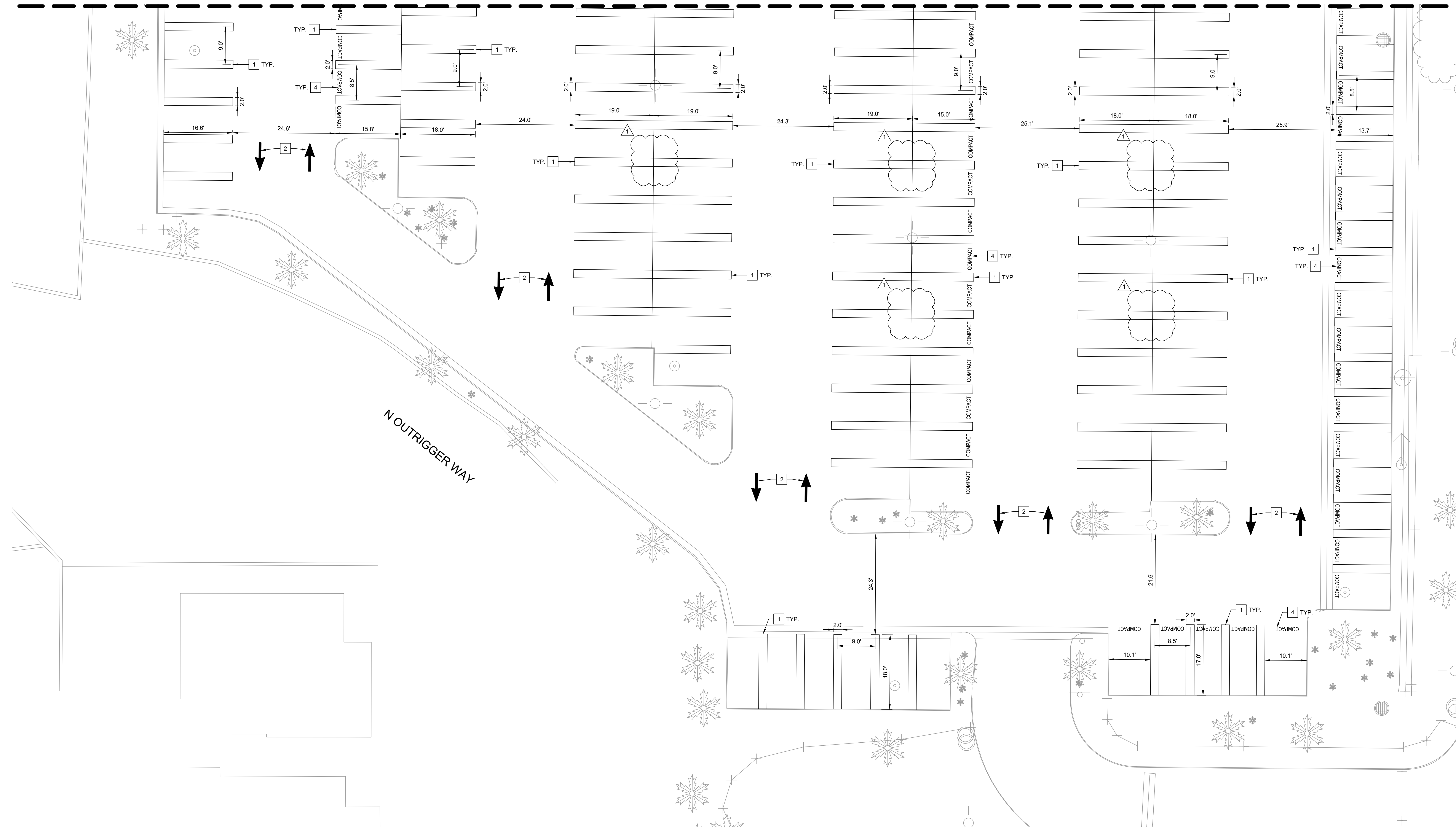

CONSTRUCTION NOTES

1. PAINT 4" WIDE WHITE PARKING STALL STRIPE (2 COATS) PER DETAIL 1 ON THIS SHEET.
2. PAINT WHITE DIRECTIONAL ARROW (2 COATS) PER DETAIL 2 ON THIS SHEET.
4. INSTALL WHITE 12" HEIGHT "COMPACT" LETTERS.

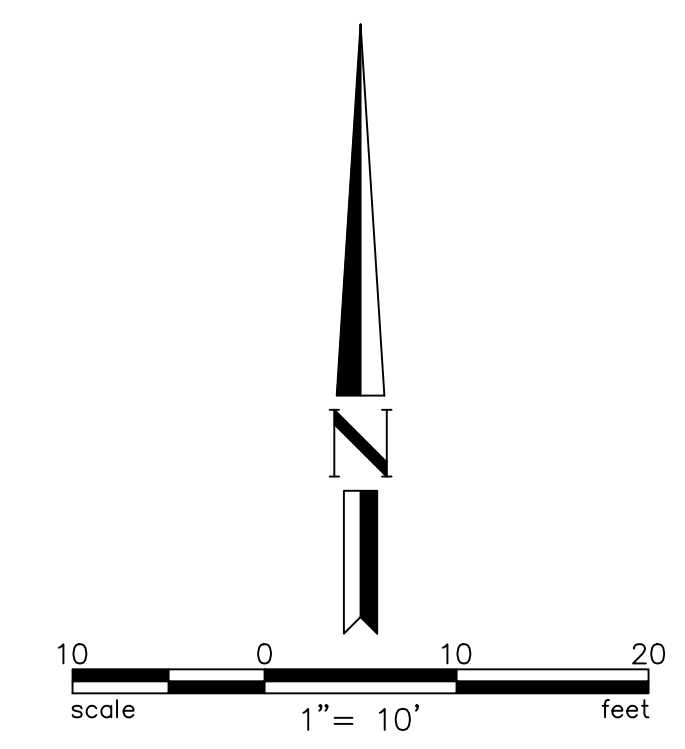

JURISDICTION Division of the State Architect San Diego Regional Office 10920 Via Frontera, Suite 300 San Diego, CA 92127 ph: 616.674.5400		DIGALERT DIAL BEFORE YOU DIG TWO WORKING DAYS BEFORE YOU DIG TOLL FREE 1-800-227-2600 A PUBLIC SERVICE BY UNDERGROUND SERVICE ALERT		REVISIONS NO. DESCRIPTION DATE BY 1 ADDENDUM 1 - CURB PLANTER REMOVAL 2/18/22 ATR		PROFESSIONAL ENGINEER C 83702 EXP. 3/31/23 DAVID EVANS AND ASSOCIATES INC. PREPARED UNDER THE SUPERVISION OF: ANDREW RAPPE DATE: 03/15/22		NORTH ORANGE COUNTY COMMUNITY COLLEGE PARKING LOT RENOVATION DRAWN BY: TRCE DESIGNED BY: ATR CHECKED BY: MSO SCALE: DATE: 05/12/20 SHT NO.: C3.1	
---	--	--	--	--	--	--	--	---	--

LEGEND

4" AC OVER 6" AGGREGATE BASE
OVER 12" OF SCARIFIED AND
RECOMPACTED SUBGRADE

4" AC OVER 8" AGGREGATE BASE
OVER 12" OF SCARIFIED AND
RECOMPACTED SUBGRADE

GENERAL NOTES

1. ALL UTILITIES WITHIN THE CONSTRUCTION LIMITS ARE TO BE PROTECTED IN PLACE.
2. ALL UTILITY STRUCTURES ARE TO BE ADJUSTED TO FINAL GRADE.
3. CONTRACTOR SHALL FIELD VERIFY A.C. JOIN LIMITS PRIOR TO CONSTRUCTION.
4. LANDSCAPE INCLUDES ALL VEGETATION, TREES, AND BUSHES WITHIN THE GENERAL AREA.

CONSTRUCTION NOTES

1. PROTECT IN PLACE. AS NOTED.
2. REMOVE FULL DEPTH OF EXISTING A.C., INCLUDING BASE.
3. CONSTRUCT 4" A.C. OVER 8" OF COMPACTED AGGREGATE BASE OVER 12" OF SCARIFIED, MOISTURE CONDITIONED AND RECOMPACTED SUBGRADE PER SOILS REPORT.
4. CONSTRUCT 4" A.C. OVER 6" OF COMPACTED AGGREGATE BASE OVER 12" OF SCARIFIED, MOISTURE CONDITIONED AND RECOMPACTED SUBGRADE PER SOILS REPORT.
5. PROTECT EXISTING UTILITY IN PLACE. ADJUST AS REQUIRED.
6. REMOVE EXISTING CURB, INCLUDING BASE, AND LANDSCAPING. REMOVE SPRINKLER HEADS AND CAP IRRIGATION RISERS WITHIN LANDSCAPED AREA.

ABBREVIATIONS

FC FENCE
GUT GUTTER
LS LANDSCAPE
MH MANHOLE
PVMT PAVEMENT
SD STORM DRAIN
SL STREET LAMP
TS TRAFFIC SIGN
UB UTILITY BOX

SEE SHEET C2.0 FOR MATCHLINE

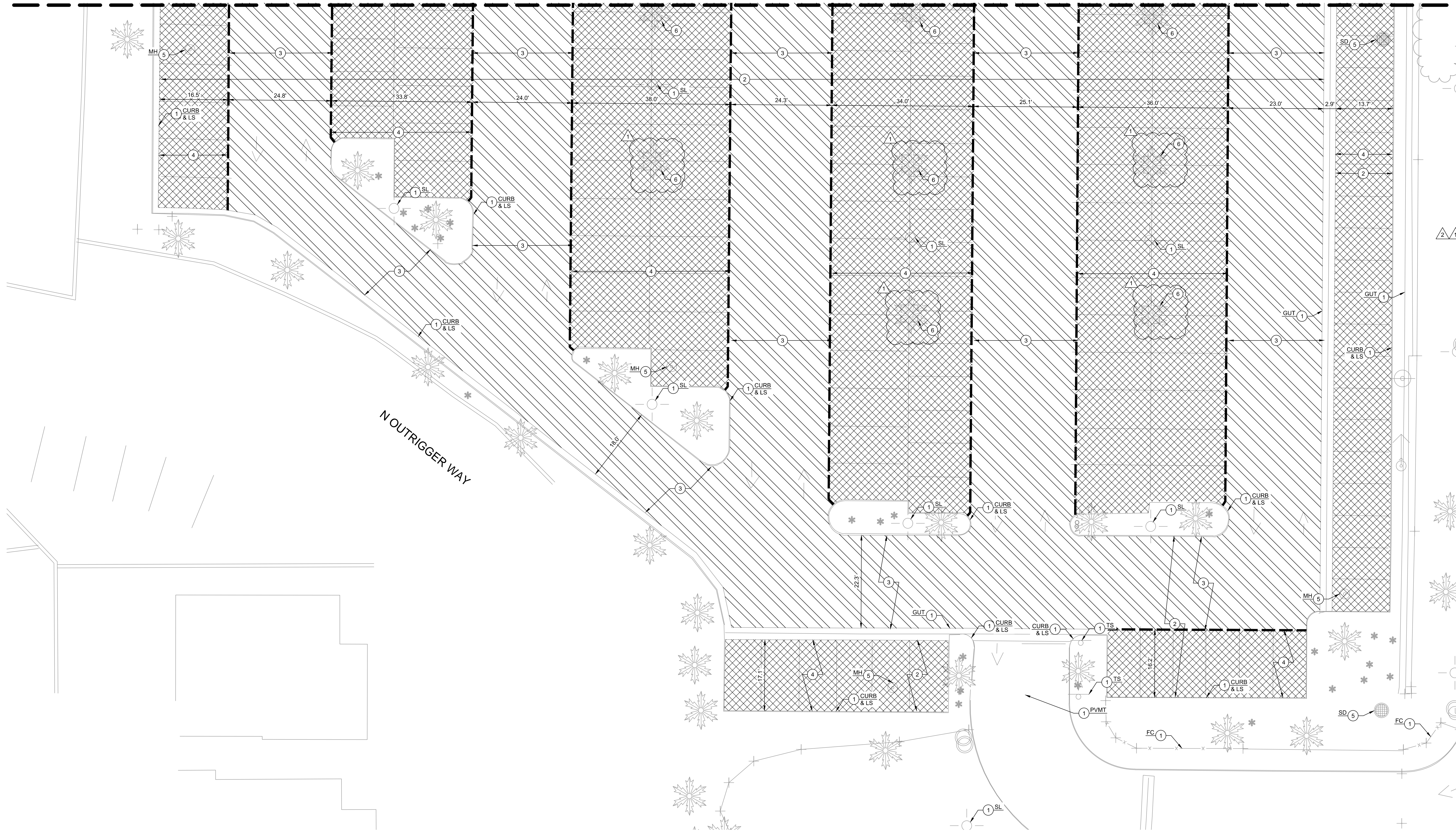

JURISDICTION

Division of the State Architect
San Diego Regional Office
10920 Via Frontera, Suite 300
San Diego, CA 92127
ph: 658.674.5400



TOLL FREE 1-800-227-2600
A PUBLIC SERVICE BY UNDERGROUND SERVICE ALERT

NO.	DESCRIPTION	DATE	BY
2	SPRINKLER REMOVAL NOTE	3/30/22	ATR
1	ADDENDUM 1 - CURB PLANTER REMOVAL	2/18/22	ATR
REVISIONS			

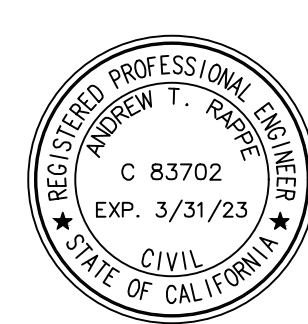

17782 17th Street Suite 200
Tustin California 92780-1947
Phone: 714.665.4500

PREPARED UNDER THE SUPERVISION OF:

Andrew Rappe
P.E. C83702
DATE: 3/30/22

NORTH ORANGE COUNTY COMMUNITY COLLEGE

PARKING LOT RENOVATION

DRAWN BY: TRCE	SCALE:
DESIGNED BY: ATR	DATE: 05/12/20
CHECKED BY: MSO	SHT NO.: C2.1

LEGEND

- 4" AC OVER 6" AGGREGATE BASE
OVER 12" OF SCARIFIED AND
RECOMPACTED SUBGRADE
- 4" AC OVER 8" AGGREGATE BASE
OVER 12" OF SCARIFIED AND
RECOMPACTED SUBGRADE

GENERAL NOTES

1. ALL UTILITIES WITHIN THE CONSTRUCTION LIMITS ARE TO BE PROTECTED IN PLACE.
2. ALL UTILITY STRUCTURES ARE TO BE ADJUSTED TO FINAL GRADE.
3. CONTRACTOR SHALL FIELD VERIFY A.C. JOIN LIMITS PRIOR TO CONSTRUCTION.
4. LANDSCAPE INCLUDES ALL VEGETATION, TREES, AND BUSHES WITHIN THE GENERAL AREA.

CONSTRUCTION NOTES

1. PROTECT IN PLACE. AS NOTED.
2. REMOVE FULL DEPTH OF EXISTING A.C., INCLUDING BASE.
3. CONSTRUCT 4" A.C. OVER 8" OF COMPACTED AGGREGATE BASE OVER 12" OF SCARIFIED, MOISTURE CONDITIONED AND RECOMPACTED SUBGRADE PER SOILS REPORT.
4. CONSTRUCT 4" A.C. OVER 6" OF COMPACTED AGGREGATE BASE OVER 12" OF SCARIFIED, MOISTURE CONDITIONED AND RECOMPACTED SUBGRADE PER SOILS REPORT.
5. PROTECT EXISTING UTILITY IN PLACE. ADJUST AS REQUIRED.
6. REMOVE EXISTING CURB, INCLUDING BASE, AND LANDSCAPING. REMOVE SPRINKLER HEADS AND CAP IRRIGATION RISERS WITHIN LANDSCAPED AREA.

ABBREVIATIONS

- GUT GUTTER
LS LANDSCAPE
PVMT PAVEMENT
MH MANHOLE
SD STORM DRAIN
SL STREET LAMP
TS TRAFFIC SIGN
UB UTILITY BOX

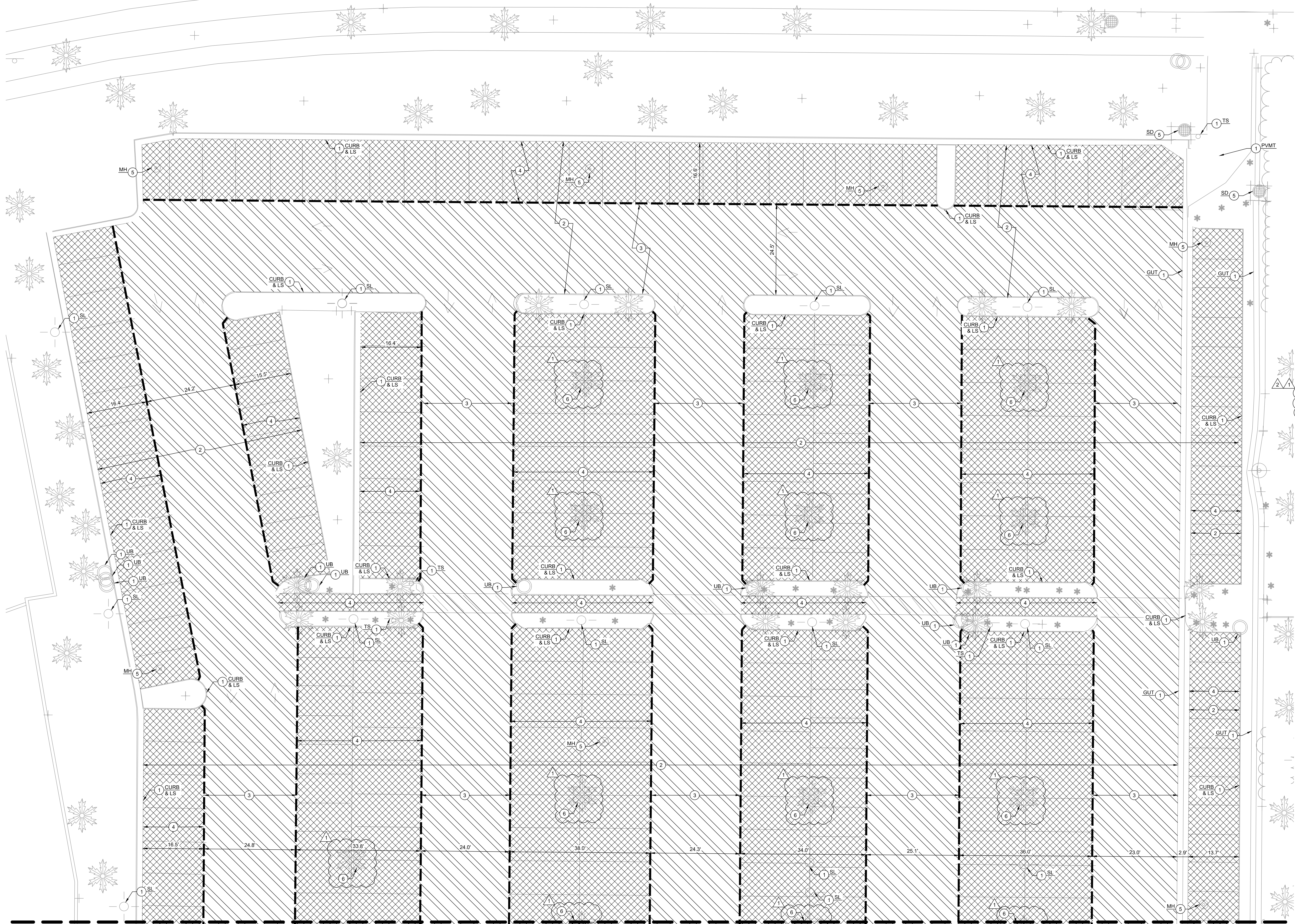

SEE SHEET C2.1 FOR MATCHLINE

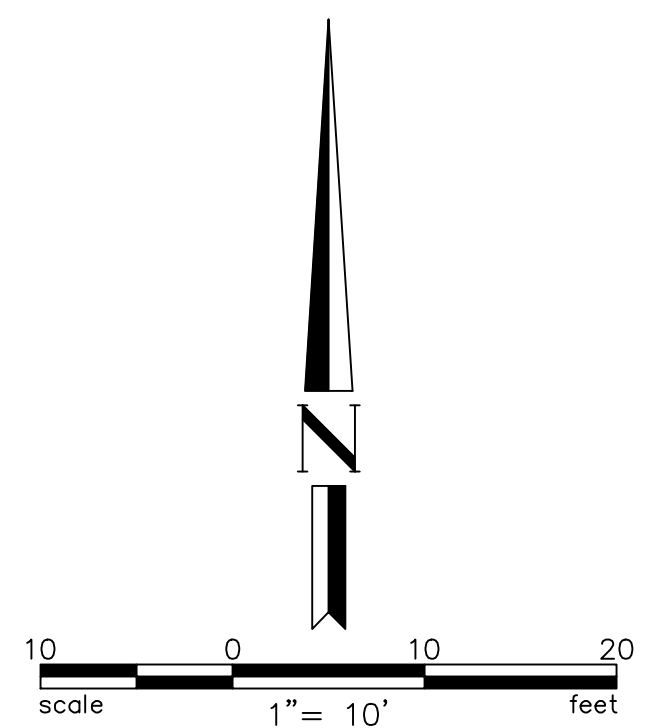

JURISDICTION

Division of the State Architect
San Diego Regional Office
10920 Via Frontera, Suite 300
San Diego, CA 92127
ph: 618.674.5400

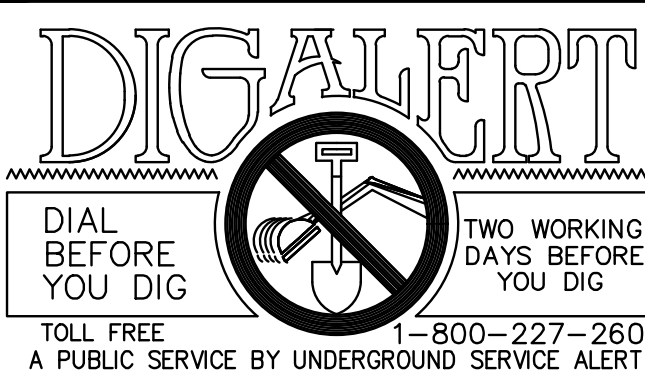

NO.	DESCRIPTION	DATE	BY
2	SPRINKLER REMOVAL NOTE	3/30/22	ATR
1	ADDENDUM 1 - CURB PLANTER REMOVAL	2/18/22	ATR
REVISIONS			

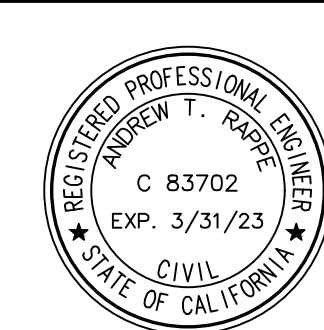

17782 17th Street Suite 200
Tustin California 92780-1947
Phone: 714.665.4500

PREPARED UNDER THE SUPERVISION OF:

ANDREW RAPPE
P.E. C83702

NORTH ORANGE COUNTY COMMUNITY COLLEGE

PARKING LOT RENOVATION

DRAWN BY: TRCE	SCALE:
DESIGNED BY: ATR	DATE: 05/12/20
CHECKED BY: MSO	SHT NO.: C2.0